

PETITION TO AMEND THE BOUNDARIES OF  
VILLAGE COMMUNITY DEVELOPMENT DISTRICT No. 9  
PURSUANT TO FLORIDA STATUTES 190.046

Petitioner, Village Community Development District No. 9, a Community Development District duly established by an ordinance of Sumter County, Florida, pursuant to the powers set forth in Chapter 190, Florida Statutes, petitions the City of Wildwood, Florida (hereinafter referred to as "City"), pursuant to the Uniform Community Development District Act of 1980, Chapter 190, Florida Statutes, to adopt an ordinance amending the ordinance heretofore adopted establishing the Village Community Development District No. 9 (hereinafter referred to as the "District") by adding 11.1 acres, more or less, to the District.

1. Petitioner is a Community Development District duly established by an ordinance of Sumter County, Florida, pursuant to the powers set forth in Chapter 190, Florida Statutes, with its principal place of business at 984 Old Mill Run, The Villages, Florida 32162.

2. The land area within the District after the boundary amendment as requested would comprise approximately 1,309.8 acres. A map showing the location of the land area in the District and its location if this amendment is approved is attached as Exhibit "1", and lies within the City. A map and legal description of the external boundaries of the District as it exists today is shown as Exhibit "2" attached hereto, Exhibit "3" is a map and legal description of the area which Petitioner proposes to add to the District. There should be a positive impact of the expanded District on the real property to be included in the District, since the area will be served by roadways and associated drainage and water management facilities which will be operated and maintained by the District. Exhibit "4" is a map and legal description of the District after the proposed amendment.

3. The five persons currently serving as the member of the Board of Supervisors of the District who shall serve in the office until replaced are named in Exhibit "5."

4. It is proposed to continue with the name "Village Community Development District No. 9."

5. The land use is PUD and is included within the Villages of Wildwood Development of Regional Impact and is shown in Exhibit "6."

6. The Developer intends to construct 265 apartment units including corresponding structures, roadways, drainage and storm water management facilities, parking and amenities (the "Improvements") within the expanded District.

7. The District shall have the authority to impose assessments on the future residents of the real property constructed within the expanded District pursuant to the authority granted under Chapter 190, Florida Statutes.

8. Such assessments imposed on the future residents within the expanded District shall include certain assessments imposed by the District under (i) Chapter 190 of the Florida

Statutes; and (ii) that certain Declaration of Covenants, Conditions and Restrictions for The Villages of Wildwood Atwood Bungalows recorded in Official Record Book 3433, Page 145 as amended by that certain First Amendment to Declaration of Covenants, Conditions and Restrictions for The Villages of Wildwood Atwood Bungalows recorded in Official Records Book 3451, Page 48 of the Public Records of Sumter County, Florida (collectively, the "Declaration") including but not limited to any Contractual Amenities Fees, as that term is defined therein.

WHEREFORE, Petitioner respectfully requests the City to: Schedule a public hearing to consider this Petition in accordance with law. Grant the Petition and adopt an ordinance amending the original ordinance establishing the District as amended, adding the lands described on Exhibit "3."

RESPECTFULLY submitted this \_\_\_\_\_ day of \_\_\_\_\_, 2020.

VILLAGE COMMUNITY DEVELOPMENT DISTRICT NO. 9

By:\_\_\_\_\_

EXHIBIT 1

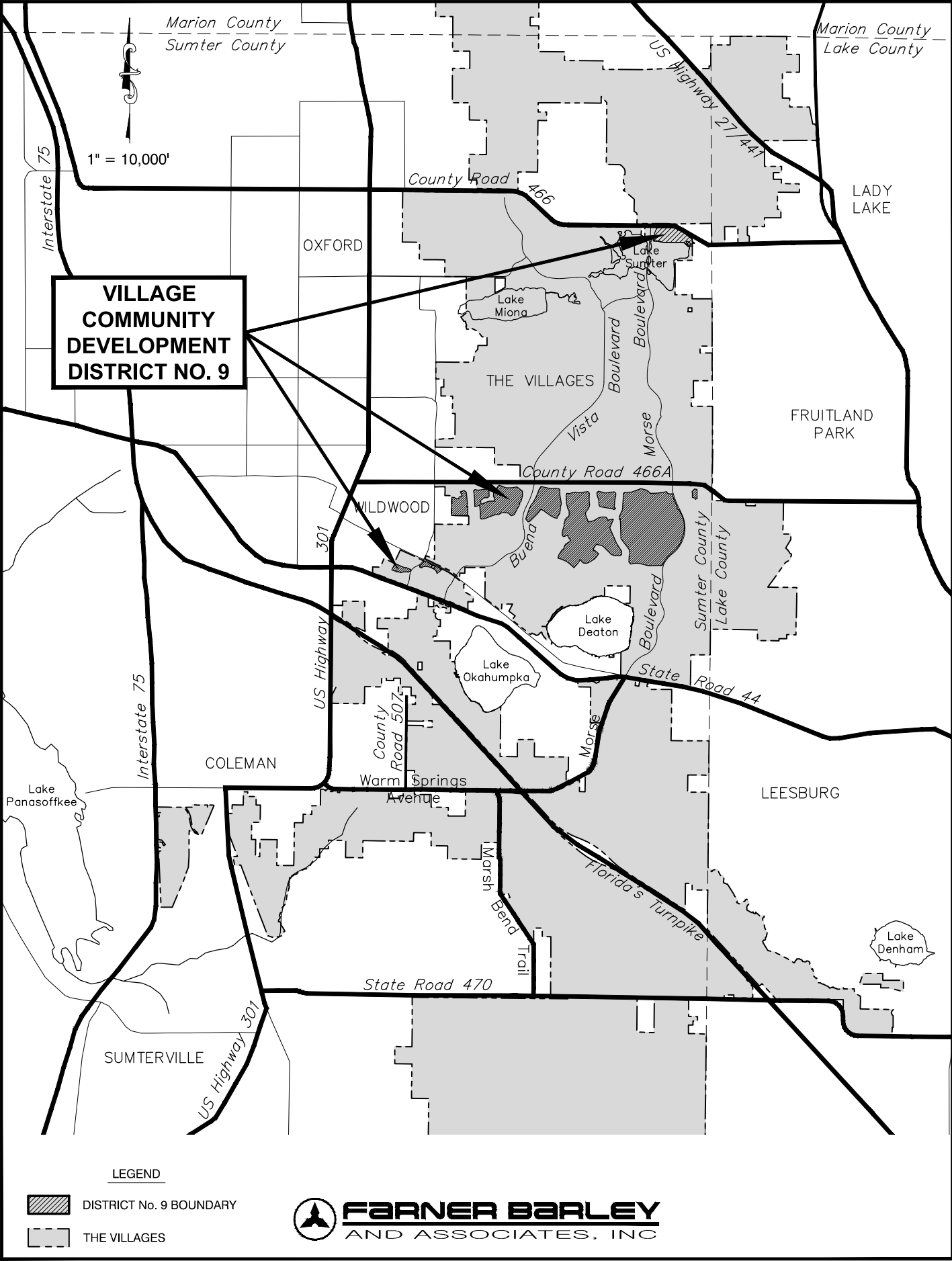

GENERAL LOCATION MAP

EXHIBIT 2

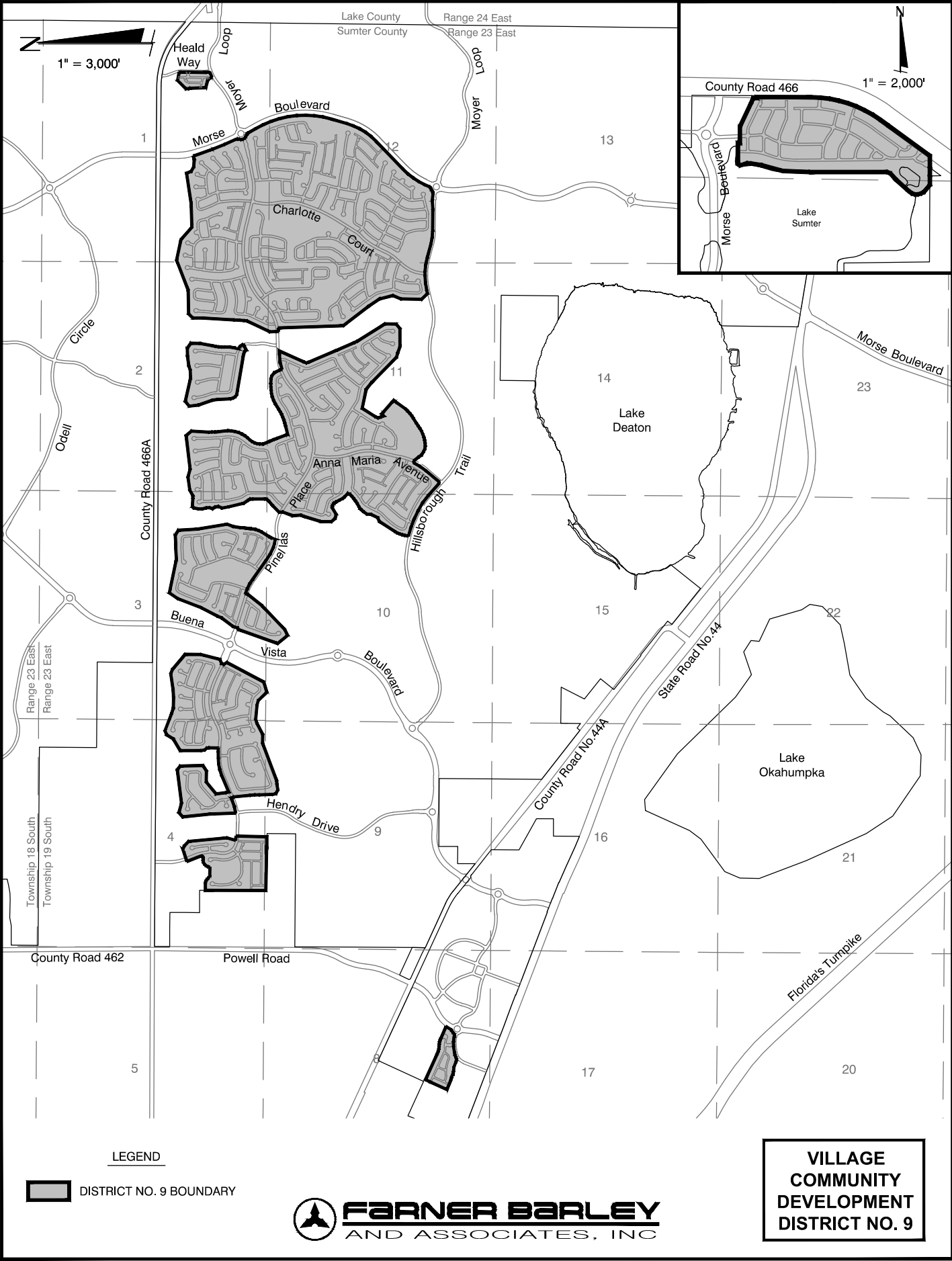

## **EXHIBIT "2"**

### **DESCRIPTION OF THE AMENDED VILLAGE COMMUNITY DEVELOPMENT DISTRICT NO. 9 APPROXIMATELY 1298.7 ACRES**

THAT LAND LYING IN SECTIONS 1, 2, 11 AND 12, TOWNSHIP 19 SOUTH, RANGE 23 EAST, SUMTER COUNTY, FLORIDA, DESCRIBED AS FOLLOWS:

FROM THE SOUTHEAST CORNER OF THE SOUTHEAST 1/4 OF SAID SECTION 2 RUN N00°28'41"E, ALONG THE EAST LINE THEREOF A DISTANCE OF 579.09 FEET; THENCE DEPARTING SAID EAST LINE, N89°31'19"W, 1,314.06 FEET TO THE POINT OF BEGINNING; THENCE N05°37'01"E, 64.18 FEET; THENCE N03°23'36"E, 965.29 FEET; THENCE N00°27'12"E, 224.33 FEET; THENCE N44°31'02"E, 136.96 FEET; THENCE N88°34'52"E, 552.22 FEET; THENCE N68°52'57"E, 747.55 FEET; THENCE S77°33'55"E, 490.96 FEET; THENCE S48°28'04"E, 378.86 FEET; THENCE N88°17'40"E, 541.22 FEET; THENCE N81°33'50"E, 727.04 FEET; THENCE S21°20'47"E, 114.32 FEET; THENCE S60°37'44"E, 117.99 FEET; THENCE S84°52'44"E, 113.69 FEET; THENCE N89°54'48"E, 77.13 FEET; THENCE N72°17'25"E, 60.03 FEET TO A POINT ON THE ARC OF A CURVE CONCAVE EASTERLY, HAVING A RADIUS OF 6,084.00 FEET AND A CHORD BEARING AND DISTANCE OF S19°53'41"E, 463.88 FEET; THENCE SOUTHERLY ALONG THE ARC OF SAID CURVE, THROUGH A CENTRAL ANGLE OF 04°22'11", A DISTANCE OF 464.00 FEET TO THE POINT OF REVERSE CURVATURE OF A CURVE CONCAVE WESTERLY AND HAVING A RADIUS OF 500.00 FEET; THENCE SOUTHERLY ALONG THE ARC OF SAID CURVE THROUGH A CENTRAL ANGLE OF 01°53'03", A DISTANCE OF 16.44 FEET TO THE POINT OF REVERSE CURVATURE OF A CURVE CONCAVE NORTHEASTERLY AND HAVING A RADIUS OF 6,060.00 FEET; THENCE SOUTHEASTERLY ALONG THE ARC OF SAID CURVE THROUGH A CENTRAL ANGLE OF 05°36'01", A DISTANCE OF 592.31 FEET TO THE POINT OF REVERSE CURVATURE OF A CURVE CONCAVE WESTERLY AND HAVING A RADIUS OF 75.00 FEET; THENCE SOUTHERLY ALONG THE ARC OF SAID CURVE THROUGH A CENTRAL ANGLE OF 48°19'26", A DISTANCE OF 63.26 FEET TO THE POINT OF REVERSE CURVATURE OF A CURVE CONCAVE NORTHEASTERLY AND HAVING A RADIUS OF 131.00 FEET; THENCE SOUTHEASTERLY ALONG THE ARC OF SAID CURVE THROUGH A CENTRAL ANGLE OF 99°35'12", A DISTANCE OF 227.69 FEET TO THE POINT OF REVERSE CURVATURE OF A CURVE CONCAVE SOUTHWESTERLY AND HAVING A RADIUS OF 75.00 FEET; THENCE SOUTHEASTERLY ALONG THE ARC OF SAID CURVE THROUGH A CENTRAL ANGLE OF 48°19'26", A DISTANCE OF 63.26 FEET TO THE POINT OF REVERSE CURVATURE OF A CURVE CONCAVE NORTHEASTERLY AND HAVING A RADIUS OF 6,060.00 FEET; THENCE SOUTHEASTERLY ALONG THE ARC OF SAID CURVE THROUGH A CENTRAL ANGLE OF 01°55'56", A DISTANCE OF 204.38 FEET TO THE POINT OF REVERSE CURVATURE OF A CURVE CONCAVE WESTERLY AND HAVING A RADIUS OF 2,240.00 FEET; THENCE SOUTHERLY ALONG THE ARC OF SAID CURVE THROUGH A CENTRAL ANGLE OF 47°03'04", A DISTANCE OF 1,839.48 FEET; THENCE S16°23'04"W, 364.83 FEET TO THE POINT OF CURVATURE OF A CURVE CONCAVE NORTHWESTERLY AND HAVING A RADIUS OF 1,545.00 FEET; THENCE

SOUTHWESTERLY ALONG THE ARC THEREOF THROUGH A CENTRAL ANGLE OF 29°44'49", A DISTANCE OF 802.14 FEET; THENCE S46°07'53"W, 902.91 FEET TO THE POINT OF CURVATURE OF A CURVE CONCAVE SOUTHEASTERLY AND HAVING A RADIUS OF 1,635.00 FEET; THENCE SOUTHWESTERLY ALONG THE ARC THEREOF THROUGH A CENTRAL ANGLE OF 21°44'11", A DISTANCE OF 620.27 FEET; THENCE S24°23'42"W, 125.69 FEET TO THE POINT OF CURVATURE OF A CURVE CONCAVE NORTHWESTERLY AND HAVING A RADIUS OF 50.00 FEET; THENCE SOUTHWESTERLY ALONG THE ARC THEREOF THROUGH A CENTRAL ANGLE OF 52°31'28", A DISTANCE OF 45.84 FEET TO THE POINT OF REVERSE CURVATURE OF A CURVE CONCAVE SOUTHEASTERLY AND HAVING A RADIUS OF 131.00 FEET; THENCE SOUTHWESTERLY ALONG THE ARC OF SAID CURVE THROUGH A CENTRAL ANGLE OF 33°28'01", A DISTANCE OF 76.52 FEET TO THE POINT OF REVERSE CURVATURE OF A CURVE CONCAVE NORTHERLY AND HAVING A RADIUS OF 50.00 FEET; THENCE WESTERLY ALONG THE ARC OF SAID CURVE THROUGH A CENTRAL ANGLE OF 56°24'29", A DISTANCE OF 49.23 FEET TO A POINT ON THE ARC OF A CURVE CONCAVE SOUTHERLY, HAVING A RADIUS OF 951.57 FEET AND A CHORD BEARING AND DISTANCE OF N85°06'45"W, 164.29 FEET; THENCE WESTERLY ALONG THE ARC OF SAID CURVE, THROUGH A CENTRAL ANGLE OF 09°54'16", A DISTANCE OF 164.50 FEET TO A POINT ON THE ARC OF A CURVE CONCAVE SOUTHERLY, HAVING A RADIUS OF 257.00 FEET AND A CHORD BEARING AND DISTANCE OF S88°43'58"W, 16.39 FEET; THENCE WESTERLY ALONG THE ARC OF SAID CURVE, THROUGH A CENTRAL ANGLE OF 03°39'13", A DISTANCE OF 16.39 FEET; THENCE S86°54'22"W, 195.81 FEET; THENCE N89°26'26"W, 515.43 FEET TO THE POINT OF CURVATURE OF A CURVE CONCAVE NORTHERLY AND HAVING A RADIUS OF 1,170.00 FEET; THENCE WESTERLY ALONG THE ARC THEREOF THROUGH A CENTRAL ANGLE OF 14°25'28", A DISTANCE OF 294.55 FEET; THENCE N75°00'58"W, 336.64 FEET TO THE POINT OF CURVATURE OF A CURVE CONCAVE SOUTHERLY AND HAVING A RADIUS OF 1,530.00 FEET; THENCE WESTERLY ALONG THE ARC THEREOF THROUGH A CENTRAL ANGLE OF 28°33'23", A DISTANCE OF 762.56 FEET; THENCE S76°25'39"W, 76.46 FEET; THENCE N43°45'02"W, 197.22 FEET; THENCE N01°26'35"E, 481.01 FEET; THENCE N22°24'01"E, 199.74 FEET; THENCE N14°18'44"W, 322.92 FEET; THENCE N33°33'44"W, 284.70 FEET; THENCE N37°35'50"W, 762.86 FEET; THENCE N01°52'00"W, 1,514.01 FEET TO A POINT ON THE ARC OF A CURVE CONCAVE NORTHERLY, HAVING A RADIUS OF 1,030.00 FEET AND A CHORD BEARING AND DISTANCE OF S83°25'10"W, 81.30 FEET; THENCE WESTERLY ALONG THE ARC OF SAID CURVE, THROUGH A CENTRAL ANGLE OF 04°31'26", A DISTANCE OF 81.33 FEET; THENCE N04°19'07"W, 60.00 FEET; THENCE N01°20'38"W, 143.27 FEET; THENCE N25°11'55"E, 594.57 FEET TO THE POINT OF BEGINNING.

AND

THAT LAND LYING IN SECTION 2, TOWNSHIP 19 SOUTH, RANGE 23 EAST, SUMTER COUNTY, FLORIDA, DESCRIBED AS FOLLOWS:

FROM THE SOUTHWEST CORNER OF THE SOUTHEAST 1/4 OF SAID SECTION 2 RUN S89°28'14"E, ALONG THE SOUTH LINE THEREOF A DISTANCE OF 555.97 FEET;

THENCE DEPARTING SAID SOUTH LINE, N00°31'46"E, 641.12 FEET TO THE POINT OF BEGINNING; THENCE N80°12'32"W, 966.06 FEET; THENCE N53°14'46"W, 54.40 FEET; THENCE N31°06'53"W, 60.08 FEET; THENCE N18°10'23"W, 62.33 FEET; THENCE N01°54'15"W, 311.74 FEET; THENCE N09°25'59"W, 105.94 FEET; THENCE N19°25'39"W, 349.63 FEET; THENCE N06°04'24"W, 217.95 FEET; THENCE N50°58'18"E, 143.37 FEET; THENCE S77°03'48"E, 555.54 FEET; THENCE N87°41'44"E, 189.20 FEET; THENCE N70°10'02"E, 97.86 FEET; THENCE N82°40'11"E, 224.40 FEET; THENCE N88°55'59"E, 192.26 FEET; THENCE S55°12'04"E, 137.27 FEET; THENCE S01°01'44"W, 214.13 FEET; THENCE S10°31'15"W, 301.40 FEET; THENCE S10°27'51"W, 69.66 FEET; THENCE S08°02'16"W, 68.07 FEET; THENCE S04°22'29"W, 68.07 FEET; THENCE S00°58'46"W, 68.82 FEET; THENCE S00°18'00"W, 124.60 FEET; THENCE S09°47'28"W, 202.88 FEET TO A POINT ON THE ARC OF A CURVE CONCAVE SOUTHWESTERLY, HAVING A RADIUS OF 275.00 FEET AND A CHORD BEARING AND DISTANCE OF S43°39'41"E, 152.38 FEET; THENCE SOUTHEASTERLY ALONG THE ARC OF SAID CURVE, THROUGH A CENTRAL ANGLE OF 32°10'10", A DISTANCE OF 154.40 FEET; THENCE S62°25'25"W, 160.00 FEET; THENCE N41°23'55"W, 54.95 FEET; THENCE N69°12'45"W, 56.43 FEET TO THE POINT OF BEGINNING.

AND

THAT LAND LYING IN SECTIONS 2, 3, 10 AND 11, TOWNSHIP 19 SOUTH, RANGE 23 EAST, SUMTER COUNTY, FLORIDA, DESCRIBED AS FOLLOWS:

FROM THE NORTHEAST CORNER OF THE NORTHEAST 1/4 OF SAID SECTION 10 RUN S00°40'50"W, ALONG THE EAST LINE THEREOF A DISTANCE OF 294.91 FEET; THENCE DEPARTING SAID EAST LINE, N89°19'10"W, 457.38 FEET TO THE POINT OF BEGINNING; THENCE N07°24'44"W, 74.47 FEET; THENCE N45°46'15"E, 222.64 FEET; THENCE N49°01'45"E, 140.00 FEET; THENCE N44°00'29"E, 54.87 FEET; THENCE N09°11'06"E, 48.86 FEET; THENCE N00°07'40"W, 280.00 FEET; THENCE N02°56'01"W, 60.57 FEET; THENCE N27°27'57"W, 55.10 FEET; THENCE N34°39'04"W, 122.13 FEET; THENCE N13°22'35"W, 369.23 FEET; THENCE N10°19'03"W, 149.93 FEET; THENCE N23°05'27"E, 90.92 FEET; THENCE N08°59'29"W, 76.25 FEET; THENCE N31°56'01"W, 74.23 FEET; THENCE N19°24'07"E, 74.93 FEET; THENCE N04°42'23"W, 73.10 FEET; THENCE N15°05'25"W, 93.65 FEET; THENCE N00°01'07"E, 94.72 FEET; THENCE N12°45'30"E, 105.66 FEET; THENCE N34°51'18"E, 45.21 FEET; THENCE S86°30'43"E, 196.76 FEET; THENCE S89°15'25"E, 59.80 FEET; THENCE N61°14'05"E, 146.94 FEET; THENCE N82°23'34"E, 314.00 FEET; THENCE S75°05'29"E, 184.12 FEET; THENCE N83°23'49"E, 788.23 FEET; THENCE S40°03'37"E, 158.59 FEET; THENCE S03°03'20"W, 408.59 FEET; THENCE S00°41'28"E, 70.00 FEET; THENCE S02°06'58"E, 67.54 FEET; THENCE S05°35'03"E, 69.03 FEET; THENCE S05°51'07"E, 228.17 FEET; THENCE S02°47'32"W, 87.83 FEET; THENCE S09°33'14"W, 87.78 FEET; THENCE S16°46'38"W, 87.72 FEET; THENCE S23°45'20"W, 81.84 FEET; THENCE S30°29'30"W, 78.75 FEET; THENCE S37°06'20"W, 81.81 FEET; THENCE S43°04'19"W, 74.75 FEET; THENCE S35°36'02"W, 63.66 FEET; THENCE S26°35'09"W, 63.66 FEET; THENCE S17°34'16"W, 63.66 FEET; THENCE S08°33'22"W, 63.66 FEET; THENCE S01°07'05"E, 72.94 FEET; THENCE S22°13'09"E, 159.25 FEET; THENCE S23°00'10"E, 107.25 FEET; THENCE S20°22'53"E, 301.08 FEET; THENCE

S14°21'25"E, 46.45 FEET; THENCE N75°38'35"E, 210.00 FEET; THENCE N75°37'04"E, 69.70 FEET; THENCE N73°18'09"E, 73.78 FEET; THENCE N69°30'44"E, 72.40 FEET; THENCE N65°53'01"E, 67.55 FEET; THENCE N62°22'50"E, 67.55 FEET; THENCE N58°52'39"E, 67.55 FEET; THENCE N56°54'25"E, 69.84 FEET; THENCE N56°56'44"E, 75.59 FEET; THENCE N63°11'51"E, 91.33 FEET; THENCE N71°00'48"E, 91.34 FEET; THENCE N77°13'41"E, 80.89 FEET; THENCE N82°52'29"E, 76.71 FEET; THENCE N85°40'05"E, 75.49 FEET; THENCE N88°48'26"E, 75.49 FEET; THENCE S88°03'00"E, 108.48 FEET; THENCE S74°09'22"E, 72.69 FEET; THENCE S52°40'29"E, 97.54 FEET; THENCE S25°00'11"E, 133.48 FEET; THENCE S19°01'54"E, 60.00 FEET TO A POINT ON THE ARC OF A CURVE CONCAVE SOUTHERLY, HAVING A RADIUS OF 1,170.00 FEET AND A CHORD BEARING AND DISTANCE OF N79°43'11"E, 356.02 FEET; THENCE EASTERLY ALONG THE ARC OF SAID CURVE, THROUGH A CENTRAL ANGLE OF 17°30'10", A DISTANCE OF 357.41 FEET; THENCE N88°28'16"E, 81.88 FEET; THENCE S24°03'38"W, 633.16 FEET; THENCE S22°55'10"W, 61.76 FEET; THENCE S17°27'05"E, 52.91 FEET; THENCE S23°19'37"E, 1226.65 FEET; THENCE S32°04'29"E, 769.09 FEET; THENCE S01°08'06"W, 257.53 FEET; THENCE S49°38'02"W, 137.76 FEET; THENCE N89°36'47"W, 423.95 FEET; THENCE N71°05'11"W, 147.22 FEET; THENCE N73°32'42"W, 108.43 FEET; THENCE N45°34'06"W, 831.88 FEET; THENCE N50°49'53"W, 193.05 FEET; THENCE N78°07'02"W, 451.93 FEET; THENCE S32°43'19"W, 373.47 FEET; THENCE S24°16'56"W, 58.39 FEET; THENCE S19°06'42"E, 140.84 FEET; THENCE N46°59'04"E, 69.76 FEET; THENCE S48°38'51"E, 45.63 FEET; THENCE S48°16'04"E, 372.14 FEET; THENCE S36°38'28"W, 51.56 FEET; THENCE S46°43'20"E, 2.04 FEET; THENCE S36°13'29"W, 287.37 FEET; THENCE S43°47'00"W, 70.00 FEET; THENCE S44°32'16"W, 79.50 FEET; THENCE S53°08'44"W, 66.52 FEET; THENCE S57°49'28"W, 70.00 FEET; THENCE S57°46'45"W, 140.77 FEET; THENCE S56°33'35"W, 71.58 FEET; THENCE S56°17'10"W, 69.60 FEET; THENCE S59°49'21"W, 68.22 FEET; THENCE S65°18'02"W, 79.91 FEET; THENCE S71°14'49"W, 80.88 FEET; THENCE S76°45'39"W, 68.22 FEET; THENCE S81°46'16"W, 68.54 FEET; THENCE S84°59'18"W, 67.88 FEET; THENCE N80°19'26"W, 72.26 FEET; THENCE N63°07'40"W, 74.93 FEET; THENCE N59°48'05"W, 82.33 FEET; THENCE N34°10'54"W, 86.47 FEET; THENCE N38°15'14"W, 118.83 FEET; THENCE N64°36'25"W, 60.00 FEET TO A POINT ON THE ARC OF A CURVE CONCAVE NORTHWESTERLY, HAVING A RADIUS OF 1,370.00 FEET AND A CHORD BEARING AND DISTANCE OF S32°44'33"W, 350.51 FEET; THENCE SOUTHWESTERLY ALONG THE ARC OF SAID CURVE, THROUGH A CENTRAL ANGLE OF 14°41'57", A DISTANCE OF 351.47 FEET; THENCE S40°05'32"W, 402.38 FEET TO THE POINT OF CURVATURE OF A CURVE CONCAVE NORTHERLY AND HAVING A RADIUS OF 20.00 FEET; THENCE WESTERLY ALONG THE ARC THEREOF THROUGH A CENTRAL ANGLE OF 92°11'55", A DISTANCE OF 32.18 FEET; THENCE N47°42'33"W, 388.21 FEET TO THE POINT OF CURVATURE OF A CURVE CONCAVE SOUTHWESTERLY AND HAVING A RADIUS OF 1,130.00 FEET; THENCE NORTHWESTERLY ALONG THE ARC THEREOF THROUGH A CENTRAL ANGLE OF 10°32'43", A DISTANCE OF 207.98 FEET TO THE POINT OF COMPOUND CURVATURE OF A CURVE CONCAVE SOUTHWESTERLY AND HAVING A RADIUS OF 2,841.98 FEET; THENCE NORTHWESTERLY ALONG THE ARC OF SAID CURVE THROUGH A CENTRAL ANGLE OF 17°07'36", A DISTANCE OF 849.52 FEET; THENCE N12°17'59"E, 88.76 FEET; THENCE N12°36'30"E, 59.94 FEET; THENCE N18°40'59"E, 59.20 FEET; THENCE N21°06'14"E, 59.97 FEET; THENCE N31°55'32"E, 60.02 FEET; THENCE N32°47'36"E, 439.51 FEET; THENCE

N66°34'01"E, 95.01 FEET; THENCE N26°17'58"E, 178.55 FEET; THENCE N00°51'57"E, 85.87 FEET; THENCE N35°11'04"E, 101.48 FEET; THENCE N40°40'33"E, 108.17 FEET; THENCE N63°26'38"E, 55.61 FEET; THENCE N59°23'00"E, 83.20 FEET; THENCE N56°52'44"E, 68.74 FEET; THENCE N53°16'59"E, 68.74 FEET; THENCE N49°41'14"E, 68.74 FEET; THENCE N46°46'33"E, 67.90 FEET; THENCE N22°13'04"E, 50.41 FEET; THENCE N46°36'13"W, 106.90 FEET; THENCE N42°34'34"W, 54.47 FEET; THENCE N27°54'37"W, 180.13 FEET; THENCE N28°46'29"W, 49.94 FEET; THENCE N41°06'56"W, 24.44 FEET; THENCE N63°31'39"W, 32.36 FEET; THENCE N73°20'53"W, 30.40 FEET; THENCE N81°58'28"W, 35.90 FEET; THENCE S58°45'12"W, 182.61 FEET; THENCE N74°18'37"W, 98.00 FEET; THENCE N39°43'09"W, 113.15 FEET; THENCE N00°05'37"W, 241.03 FEET; THENCE N16°59'44"E, 426.28 FEET; THENCE N21°52'52"E, 69.32 FEET; THENCE N04°12'39"W, 188.28 FEET; THENCE N20°19'10"E, 253.15 FEET TO THE POINT OF BEGINNING.

AND

THAT LAND LYING IN SECTIONS 3 AND 10, TOWNSHIP 19 SOUTH, RANGE 23 EAST, SUMTER COUNTY, FLORIDA, DESCRIBED AS FOLLOWS:

FROM THE NORTHWEST CORNER OF THE NORTHEAST 1/4 OF SAID SECTION 10 RUN S89°24'14"E, ALONG THE NORTH LINE THEREOF A DISTANCE OF 271.37 FEET; THENCE DEPARTING SAID NORTH LINE, N00°35'46"E, 489.36 FEET TO THE POINT OF BEGINNING; THENCE S38°40'56"W, 415.88 FEET; THENCE S46°13'31"W, 778.48 FEET; THENCE S65°44'56"W, 143.59 FEET; THENCE N39°05'25"W, 297.58 FEET; THENCE N19°35'33"E, 964.92 FEET; THENCE N58°21'40"E, 49.11 FEET; THENCE N14°30'39"E, 100.15 FEET; THENCE N37°16'30"E, 342.23 FEET; THENCE N21°43'18"E, 95.37 FEET; THENCE N27°17'34"E, 430.23 FEET; THENCE N21°11'14"E, 589.13 FEET; THENCE N34°29'35"E, 234.39 FEET; THENCE S78°15'15"E, 795.99 FEET; THENCE N86°31'03"E, 276.93 FEET; THENCE S87°02'16"E, 89.09 FEET; THENCE N86°31'03"E, 201.04 FEET; THENCE S56°59'52"E, 132.02 FEET; THENCE S03°09'20"E, 436.02 FEET; THENCE S09°32'51"E, 708.16 FEET; THENCE S20°58'25"W, 155.84 FEET; THENCE S09°23'10"W, 163.90 FEET; THENCE S02°56'28"W, 95.79 FEET; THENCE S08°37'57"W, 43.32 FEET; THENCE S06°44'50"W, 69.01 FEET; THENCE S04°51'33"W, 40.58 FEET; THENCE S08°03'00"W, 104.00 FEET; THENCE S20°01'39"W, 79.21 FEET; THENCE S23°30'47"W, 67.85 FEET; THENCE S32°33'28"W, 228.60 FEET; THENCE S26°48'04"W, 63.87 FEET; THENCE S20°03'04"W, 80.18 FEET TO A POINT ON THE ARC OF A CURVE CONCAVE NORTHERLY, HAVING A RADIUS OF 670.00 FEET AND A CHORD BEARING AND DISTANCE OF N76°03'05"W, 202.04 FEET; THENCE WESTERLY ALONG THE ARC OF SAID CURVE, THROUGH A CENTRAL ANGLE OF 17°20'36", A DISTANCE OF 202.81 FEET TO THE POINT OF COMPOUND CURVATURE OF A CURVE CONCAVE NORTHEASTERLY AND HAVING A RADIUS OF 1,470.00 FEET; THENCE NORTHWESTERLY ALONG THE ARC OF SAID CURVE THROUGH A CENTRAL ANGLE OF 12°52'10", A DISTANCE OF 330.18 FEET; THENCE N54°30'37"W, 545.62 FEET TO THE POINT OF CURVATURE OF A CURVE CONCAVE SOUTHWESTERLY AND HAVING A RADIUS OF 1,230.00 FEET; THENCE NORTHWESTERLY ALONG THE ARC THEREOF THROUGH A CENTRAL ANGLE OF 17°24'45", A DISTANCE OF 373.80 FEET; THENCE S18°04'38"W, 60.00 FEET TO THE POINT OF BEGINNING.

AND

THAT LAND LYING IN SECTIONS 3, 4 AND 9, TOWNSHIP 19 SOUTH, RANGE 23 EAST, SUMTER COUNTY, FLORIDA, DESCRIBED AS FOLLOWS:

FROM THE SOUTHWEST CORNER OF THE SOUTHWEST 1/4 OF SAID SECTION 3 RUN S89°24'01"E, ALONG THE SOUTH LINE THEREOF A DISTANCE OF 357.71 FEET; THENCE DEPARTING SAID SOUTH LINE, N00°35'59"E, 248.43 FEET TO THE POINT OF BEGINNING; THENCE S74°58'16"E, 106.05 FEET; THENCE S43°04'48"E, 274.41 FEET; THENCE N73°42'27"E, 249.54 FEET; THENCE N27°52'02"E, 972.95 FEET; THENCE N32°01'14"W, 86.01 FEET; THENCE N25°31'02"E, 60.00 FEET; THENCE N69°48'33"E, 95.94 FEET; THENCE N14°36'03"E, 462.98 FEET; THENCE N00°24'11"E, 362.75 FEET; THENCE N49°55'41"W, 457.79 FEET; THENCE N67°04'01"W, 105.72 FEET; THENCE S81°31'41"W, 387.38 FEET; THENCE S87°00'33"W, 173.03 FEET; THENCE N88°23'23"W, 240.95 FEET; THENCE N73°20'26"W, 126.53 FEET; THENCE N69°03'49"W, 438.25 FEET; THENCE S67°38'41"W, 106.78 FEET; THENCE S31°03'58"W, 176.13 FEET; THENCE S59°09'55"W, 314.53 FEET; THENCE S00°24'44"W, 489.33 FEET; THENCE S10°39'52"E, 80.46 FEET; THENCE S40°44'37"E, 66.18 FEET; THENCE S11°04'15"E, 53.09 FEET; THENCE S01°58'27"W, 216.72 FEET TO A POINT ON THE ARC OF A CURVE CONCAVE SOUTHERLY, HAVING A RADIUS OF 2,530.00 FEET AND A CHORD BEARING AND DISTANCE OF N89°00'46"W, 87.17 FEET; THENCE WESTERLY ALONG THE ARC OF SAID CURVE, THROUGH A CENTRAL ANGLE OF 01°58'27", A DISTANCE OF 87.18 FEET; THENCE S90°00'00"W, 146.33 FEET TO THE POINT OF CURVATURE OF A CURVE CONCAVE SOUTHERLY AND HAVING A RADIUS OF 1,030.00 FEET; THENCE WESTERLY ALONG THE ARC THEREOF THROUGH A CENTRAL ANGLE OF 22°43'26", A DISTANCE OF 408.51 FEET; THENCE S67°16'34"W, 422.92 FEET; THENCE N13°12'22"W, 69.88 FEET; THENCE N07°14'07"W, 228.09 FEET; THENCE N50°28'19"E, 359.32 FEET; THENCE S88°16'46"E, 258.18 FEET; THENCE N55°35'39"E, 150.02 FEET; THENCE N01°13'34"W, 529.02 FEET; THENCE N52°33'49"W, 109.22 FEET; THENCE S82°59'08"W, 789.23 FEET; THENCE N74°52'19"W, 222.42 FEET; THENCE S49°22'39"W, 131.66 FEET; THENCE S06°08'46"E, 661.96 FEET; THENCE S01°56'44"E, 578.55 FEET TO A POINT ON THE ARC OF A CURVE CONCAVE NORTHERLY, HAVING A RADIUS OF 1,270.00 FEET AND A CHORD BEARING AND DISTANCE OF N74°14'59"E, 308.39 FEET; THENCE EASTERLY ALONG THE ARC OF SAID CURVE, THROUGH A CENTRAL ANGLE OF 13°56'51", A DISTANCE OF 309.16 FEET; THENCE N67°16'34"E, 60.92 FEET; THENCE S22°43'26"E, 60.00 FEET; THENCE S05°30'41"E, 394.31 FEET; THENCE S04°59'13"E, 98.74 FEET; THENCE S01°41'15"E, 99.23 FEET; THENCE S00°58'38"E, 316.46 FEET; THENCE S12°16'49"E, 77.97 FEET; THENCE S63°14'06"E, 104.23 FEET; THENCE N81°31'46"E, 132.18 FEET; THENCE N86°27'48"E, 74.87 FEET; THENCE N69°34'12"E, 942.93 FEET; THENCE S88°35'57"E, 197.02 FEET; THENCE N62°24'00"E, 296.28 FEET; THENCE N71°41'25"E, 95.78 FEET; THENCE S84°15'10"E, 337.96 FEET TO THE POINT OF BEGINNING.

AND

THAT LAND LYING IN SECTION 4, TOWNSHIP 19 SOUTH, RANGE 23 EAST, SUMTER COUNTY, FLORIDA, DESCRIBED AS FOLLOWS:

FROM THE SOUTHEAST CORNER OF THE SOUTHWEST 1/4 OF SAID SECTION 4 RUN N89°34'47"W, ALONG THE SOUTH LINE THEREOF A DISTANCE OF 77.03 FEET TO THE POINT OF BEGINNING; THENCE CONTINUE ALONG SAID SOUTH LINE N89°34'47"W, 1,249.66 FEET TO THE WEST LINE OF THE SOUTHEAST 1/4 OF THE SOUTHWEST 1/4 OF SAID SECTION 4; THENCE DEPARTING SAID SOUTH LINE, N00°19'22"E, ALONG SAID WEST LINE AND THE NORTHERLY EXTENSION THEREOF A DISTANCE OF 1,422.59 FEET; THENCE DEPARTING SAID LINE, S89°40'38"E, 167.45 FEET; THENCE S74°52'40"E, 50.00 FEET; THENCE S56°21'02"E, 46.82 FEET; THENCE S42°00'12"E, 46.82 FEET; THENCE S23°28'31"E, 19.18 FEET TO A POINT ON THE ARC OF A CURVE CONCAVE NORTHWESTERLY, HAVING A RADIUS OF 170.00 FEET AND A CHORD BEARING AND DISTANCE OF S35°01'12"W, 9.45 FEET; THENCE SOUTHWESTERLY ALONG THE ARC OF SAID CURVE, THROUGH A CENTRAL ANGLE OF 03°11'11", A DISTANCE OF 9.45 FEET; THENCE S89°32'24"E, 249.33 FEET TO A POINT ON THE ARC OF A CURVE CONCAVE SOUTHEASTERLY, HAVING A RADIUS OF 171.00 FEET AND A CHORD BEARING AND DISTANCE OF N54°07'10"E, 259.90 FEET; THENCE NORTHEASTERLY ALONG THE ARC OF SAID CURVE, THROUGH A CENTRAL ANGLE OF 98°54'59", A DISTANCE OF 295.22 FEET TO THE POINT OF REVERSE CURVATURE OF A CURVE CONCAVE NORTHEASTERLY AND HAVING A RADIUS OF 40.00 FEET; THENCE NORTHEASTERLY ALONG THE ARC OF SAID CURVE THROUGH A CENTRAL ANGLE OF 122°10'41", A DISTANCE OF 85.30 FEET TO THE POINT OF REVERSE CURVATURE OF A CURVE CONCAVE SOUTHWESTERLY AND HAVING A RADIUS OF 3,572.15 FEET; THENCE NORTHWESTERLY ALONG THE ARC OF SAID CURVE THROUGH A CENTRAL ANGLE OF 05°38'21", A DISTANCE OF 351.58 FEET; THENCE N72°01'33"E, 298.77 FEET; THENCE S68°33'58"E, 78.77 FEET; THENCE S47°04'11"E, 150.67 FEET; THENCE S05°20'07"E, 898.97 FEET; THENCE S16°39'40"W, 204.79 FEET TO A POINT ON THE ARC OF A CURVE CONCAVE NORTHERLY, HAVING A RADIUS OF 720.00 FEET AND A CHORD BEARING AND DISTANCE OF S81°54'00"E, 103.18 FEET; THENCE EASTERLY ALONG THE ARC OF SAID CURVE, THROUGH A CENTRAL ANGLE OF 08°13'03", A DISTANCE OF 103.26 FEET; THENCE S03°59'29"W, 60.00 FEET; THENCE S01°24'38"W, 656.14 FEET TO THE POINT OF BEGINNING.  
LESS RIGHT-OF-WAY FOR COUNTY ROAD 141.

AND

THAT LAND LYING IN SECTIONS 13 AND 24, TOWNSHIP 18 SOUTH, RANGE 23 EAST, SUMTER COUNTY, FLORIDA, DESCRIBED AS FOLLOWS:

FROM THE NORTH 1/4 CORNER OF SAID SECTION 24 RUN S89°43'44"W, ALONG THE NORTH LINE THEREOF A DISTANCE OF 1,455.08 FEET TO THE SOUTHEAST CORNER OF THE WEST 200.00 FEET OF THE EAST 1/2 OF THE EAST 1/2 OF THE SOUTHWEST 1/4 OF THE SOUTHWEST 1/4 OF SAID SECTION 13 AND THE BOUNDARY OF THE LANDS DESCRIBED IN OFFICIAL RECORDS BOOK 2134, PAGE 376, PUBLIC RECORDS OF SUMTER COUNTY, FLORIDA; THENCE ALONG THE BOUNDARY OF SAID LANDS

DESCRIBED IN OFFICIAL RECORDS BOOK 2134, PAGE 376 THE FOLLOWING COURSES: N00°29'36"E, ALONG EAST LINE OF THE WEST 200.00 FEET OF THE EAST 1/2 OF THE EAST 1/2 OF THE SOUTHWEST 1/4 OF THE SOUTHWEST 1/4 OF SAID SECTION 13 A DISTANCE OF 225.92 FEET TO THE POINT OF BEGINNING; THENCE DEPARTING SAID EAST LINE, N89°26'37"W, 58.96 FEET; THENCE S72°48'01"W, 112.06 FEET; THENCE N55°50'16"W, 41.32 FEET TO THE BOUNDARY OF THE LANDS DESCRIBED IN OFFICIAL RECORDS BOOK 2134, PAGE 380, PUBLIC RECORDS OF SUMTER COUNTY, FLORIDA; THENCE DEPARTING THE LANDS DESCRIBED IN OFFICIAL RECORDS BOOK 2134, PAGE 376, N00°30'19"E, ALONG THE BOUNDARY OF SAID LANDS DESCRIBED IN OFFICIAL RECORDS BOOK 2134, PAGE 380 A DISTANCE OF 324.79 FEET TO THE BOUNDARY OF THE LANDS DESCRIBED IN OFFICIAL RECORDS BOOK 1975, PAGE 151, PUBLIC RECORDS OF SUMTER COUNTY, FLORIDA; THENCE DEPARTING THE BOUNDARY OF SAID LANDS DESCRIBED IN OFFICIAL RECORDS BOOK 2134, PAGE 380 AND ALONG THE BOUNDARY OF SAID LANDS DESCRIBED IN OFFICIAL RECORDS BOOK 1975, PAGE 151 THE FOLLOWING COURSES: S89°29'41"E, 28.17 FEET; THENCE N00°30'19"E, 254.58 FEET; THENCE N25°20'03"E, 408.99 FEET TO THE BOUNDARY OF THE LANDS DESCRIBED IN OFFICIAL RECORDS BOOK 1975, PAGE 145, PUBLIC RECORDS OF SUMTER COUNTY, FLORIDA; THENCE DEPARTING THE BOUNDARY OF SAID LANDS DESCRIBED IN OFFICIAL RECORDS BOOK, 1975, PAGE 151 AND ALONG THE BOUNDARY OF SAID LANDS DESCRIBED IN OFFICIAL RECORDS BOOK 1975, PAGE 145, N22°54'04"E, 42.10 FEET TO A POINT THAT IS 50.00 FEET SOUTH, BY PERPENDICULAR MEASUREMENT, OF THE SOUTHERLY RIGHT-OF-WAY OF C-466; THENCE PARALLEL WITH SAID RIGHT-OF-WAY THE FOLLOWING COURSES: S89°43'03"E, 914.57 FEET TO THE POINT OF CURVATURE OF A CURVE CONCAVE SOUTHERLY AND HAVING A RADIUS OF 1,790.08 FEET; THENCE EASTERLY ALONG THE ARC THEREOF THROUGH A CENTRAL ANGLE OF 35°43'25", A DISTANCE OF 1,116.11 FEET TO THE POINT OF TANGENCY; THENCE S53°59'38"E, 979.60 FEET TO THE EAST LINE OF THE EAST 1/2 OF THE SOUTHWEST 1/4 OF THE SOUTHEAST 1/4 OF SAID SECTION 13; THENCE ALONG SAID EAST LINE, S00°00'22"W, 250.98 FEET TO NORTHEAST CORNER OF THE NORTHWEST 1/4 OF THE NORTHEAST 1/4 OF SAID SECTION 24; THENCE S00°13'04"W, ALONG THE EAST LINE THEREOF A DISTANCE OF 138.69 FEET TO THE BOUNDARY OF SAID LANDS DESCRIBED IN OFFICIAL RECORDS BOOK 2134, PAGE 376; THENCE DEPARTING SAID EAST LINE AND ALONG THE BOUNDARY OF SAID LANDS DESCRIBED IN OFFICIAL RECORDS BOOK 2134, PAGE 376 THE FOLLOWING COURSES: S40°06'00"W, 144.90 FEET; THENCE S65°09'57"W, 52.23 FEET TO THE POINT OF CURVATURE OF A CURVE CONCAVE NORTHERLY AND HAVING A RADIUS OF 160.02 FEET; THENCE WESTERLY ALONG THE ARC THEREOF THROUGH A CENTRAL ANGLE OF 67°05'32", A DISTANCE OF 187.38 FEET TO THE POINT OF TANGENCY; THENCE N47°44'31"W, 279.60 FEET; THENCE N42°20'15"W, 134.30 FEET; THENCE N68°13'17"W, 50.36 FEET TO THE BOUNDARY OF THE LANDS DESCRIBED IN OFFICIAL RECORDS BOOK 2134, PAGE 373, PUBLIC RECORDS OF SUMTER COUNTY, FLORIDA; THENCE S89°54'13"W, 1,203.53 FEET; THENCE N87°27'14"W, 416.39 FEET; THENCE N74°47'41"W, 342.01 FEET; THENCE N80°29'20"W, 167.48 FEET TO THE POINT OF BEGINNING.

AND

A PARCEL OF LAND LYING WITHIN THE SOUTHEAST 1/4 OF SECTION 1, TOWNSHIP 19 SOUTH, RANGE 23 EAST, SUMTER COUNTY, FLORIDA, BEING MORE PARTICULARLY DESCRIBED AS FOLLOWS:

COMMENCE AT THE NORTHEAST CORNER OF THE SOUTHEAST 1/4 OF SAID SECTION 1; THENCE S00°42'50"W ALONG THE EAST LINE OF SAID SOUTHEAST 1/4 A DISTANCE OF 779.55 FEET TO A POINT ON THE SOUTH RIGHT OF WAY LINE OF COUNTY ROAD NUMBER 466A; THENCE ALONG SAID SOUTH RIGHT OF WAY LINE THE FOLLOWING TWO COURSES: N50°52'38"W, 460.37 FEET TO THE POINT OF CURVATURE OF A CURVE CONCAVE SOUTHWESTERLY AND HAVING A RADIUS OF 1835.08 FEET; THENCE NORTHWESTERLY ALONG THE ARC OF SAID CURVE THROUGH A CENTRAL ANGLE OF 00°30'44" FOR A DISTANCE OF 16.40 FEET TO A POINT ON THE BOUNDARY OF THE LANDS DESCRIBED IN OFFICIAL RECORDS BOOK 1811, PAGE 409, PUBLIC RECORDS OF SUMTER COUNTY, FLORIDA; THENCE ALONG SAID BOUNDARY THE FOLLOWING ELEVEN COURSES: DEPARTING SAID SOUTH RIGHT OF WAY LINE RUN S38°42'51"W, 125.45 FEET TO THE POINT OF CURVATURE OF A CURVE CONCAVE SOUTHEASTERLY AND HAVING A RADIUS OF 122.50 FEET; THENCE SOUTHWESTERLY ALONG THE ARC OF SAID CURVE THROUGH A CENTRAL ANGLE OF 19°37'20", AN ARC DISTANCE OF 41.95 FEET TO THE POINT OF TANGENCY; THENCE S19°05'31"W, 11.43 FEET TO THE POINT OF CURVATURE OF A CURVE CONCAVE EASTERLY AND HAVING A RADIUS OF 107.50 FEET; THENCE SOUTHERLY ALONG THE ARC OF SAID CURVE THROUGH A CENTRAL ANGLE OF 34°13'09", AN ARC DISTANCE OF 64.20 FEET TO THE POINT OF TANGENCY; THENCE S15°07'38"E, 10.32 FEET TO THE POINT OF CURVATURE OF A CURVE CONCAVE EASTERLY AND HAVING A RADIUS OF 94.50 FEET; THENCE SOUTHERLY ALONG THE ARC OF SAID CURVE THROUGH A CENTRAL ANGLE OF 04°14'45", AN ARC DISTANCE OF 7.00 FEET TO A POINT ON A NON-TANGENT LINE; THENCE S75°23'44"W, 133.41 FEET; THENCE N57°33'20"W, 178.49 FEET TO A POINT ON THE ARC OF A NON-TANGENT CURVE CONCAVE SOUTHWESTERLY, HAVING A RADIUS OF 1,595.32 FEET AND A CHORD BEARING AND DISTANCE OF N60°24'07"W, 131.31 FEET TO WHICH A RADIAL LINE BEARS N31°57'24"E; THENCE NORTHWESTERLY ALONG THE ARC OF SAID CURVE, THROUGH A CENTRAL ANGLE OF 04°43'02", AN ARC DISTANCE OF 131.34 FEET TO THE POINT OF COMPOUND CURVATURE OF A CURVE CONCAVE SOUTHERLY AND HAVING A RADIUS OF 1,153.68 FEET; THENCE WESTERLY ALONG THE ARC OF SAID CURVE THROUGH A CENTRAL ANGLE OF 11°41'16", AN ARC DISTANCE OF 235.34 FEET TO THE POINT OF COMPOUND CURVATURE OF A CURVE CONCAVE SOUTHERLY AND HAVING A RADIUS OF 1,770.03 FEET; THENCE WESTERLY ALONG THE ARC OF SAID CURVE THROUGH A CENTRAL ANGLE OF 02°48'11", AN ARC DISTANCE OF 86.60 FEET TO A POINT ON THE ARC OF A NON-TANGENT CURVE CONCAVE WESTERLY, HAVING A RADIUS OF 260.00 FEET AND A CHORD BEARING AND DISTANCE OF S03°30'24"E, 38.33 FEET TO WHICH A RADIAL LINE BEARS N82°15'59"E; SAID POINT ALSO BEING THE POINT OF BEGINNING; THENCE DEPARTING AFORESAID BOUNDARY RUN SOUTHERLY ALONG THE ARC OF SAID CURVE, THROUGH A

CENTRAL ANGLE OF 08°27'13", AN ARC DISTANCE OF 38.36 FEET TO THE POINT OF TANGENCY; THENCE S00°43'12"W, 582.53 FEET TO THE POINT OF CURVATURE OF A CURVE CONCAVE EASTERLY AND HAVING A RADIUS OF 310.00 FEET; THENCE SOUTHERLY ALONG THE ARC OF SAID CURVE THROUGH A CENTRAL ANGLE OF 11°18'58", AN ARC DISTANCE OF 61.23 FEET TO THE POINT OF REVERSE CURVATURE OF A CURVE CONCAVE NORTHWESTERLY AND HAVING A RADIUS OF 35.00 FEET; THENCE SOUTHWESTERLY ALONG THE ARC OF SAID CURVE THROUGH A CENTRAL ANGLE OF 78°16'52", AN ARC DISTANCE OF 47.82 FEET TO THE POINT OF REVERSE CURVATURE OF A CURVE CONCAVE SOUTHEASTERLY AND HAVING A RADIUS OF 1,027.55 FEET; THENCE SOUTHWESTERLY ALONG THE ARC OF SAID CURVE THROUGH A CENTRAL ANGLE OF 05°55'10", AN ARC DISTANCE OF 106.16 FEET TO A POINT ON A RADIAL LINE; THENCE N28°14'03"W, ALONG SAID RADIAL LINE A DISTANCE OF 111.38 FEET; THENCE N75°46'42"W, 197.54 FEET; THENCE N01°51'44"W, 368.48 FEET; THENCE N19°53'49"W, 32.30 FEET; THENCE N01°51'44"W, 63.00 FEET; THENCE N45°09'06"E, 269.74 FEET TO A POINT ON THE ARC OF A NON-TANGENT CURVE CONCAVE SOUTHERLY, HAVING A RADIUS OF 1,770.03 FEET AND A CHORD BEARING AND DISTANCE OF S80°26'57"E, 197.47 FEET TO WHICH A RADIAL LINE BEARS N06°21'11"E; SAID POINT ALSO BEING ON SAID BOUNDARY OF THE LANDS DESCRIBED IN OFFICIAL RECORDS BOOK 1811, PAGE 409; THENCE EASTERLY ALONG THE ARC OF SAID CURVE AND SAID BOUNDARY, THROUGH A CENTRAL ANGLE OF 06°23'44", AN ARC DISTANCE OF 197.58 FEET TO THE POINT OF BEGINNING.

AND

THAT LAND LYING IN SECTION 8, TOWNSHIP 19 SOUTH, RANGE 23 EAST, SUMTER COUNTY, FLORIDA, DESCRIBED AS FOLLOWS:

BEGIN AT THE MOST WESTERLY CORNER OF LOT 32, VILLAGES OF WILDWOOD ALDEN BUNGALOWS, ACCORDING TO THE PLAT THEREOF AS RECORDED IN PAT BOOK 15, PAGES 20, 20A THROUGH 20D, INCLUSIVE, PUBLIC RECORDS OF SUMTER COUNTY, FLORIDA; THE FOLLOWING NINE (9) COURSES BEING ALONG THE SOUTHWESTERLY BOUNDARY LINE OF LOTS 10 THROUGH 32, INCLUSIVE, AND TRACT 'H' OF AFORESAID PLAT: RUN S65°11'41"E, 656.85 FEET; THENCE S70°02'15"E, 57.09 FEET; THENCE S75°49'16"E, 61.91 FEET; THENCE S81°27'56"E, 61.87 FEET; THENCE S86°19'02"E, 51.75 FEET; THENCE S82°26'11"E, 47.51 FEET; THENCE S75°37'23"E, 40.55 FEET; THENCE S69°21'04"E, 40.55 FEET; THENCE S66°22'30"E, 309.36 FEET TO A POINT ON THE ARC OF A NON-TANGENT CURVE CONCAVE SOUTHEASTERLY, HAVING A RADIUS OF 760.00 FEET AND A CHORD BEARING AND DISTANCE OF S30°34'55"W, 129.89 FEET TO WHICH A RADIAL LINE BEARS N54°30'57"W; SAID POINT ALSO BEING ON THE WESTERLY RIGHT OF WAY LINE OF POWELL ROAD PER OFFICIAL RECORDS BOOK 2088, PAGE 199, PUBLIC RECORDS OF SUMTER COUNTY, FLORIDA; THE FOLLOWING THREE (3) COURSES BEING ALONG SAID WESTERLY RIGHT OF WAY LINE AND WESTERLY RIGHT OF WAY LINE OF SAID POWELL ROAD PER OFFICIAL RECORDS BOOK 2434, PAGE 807, PUBLIC RECORDS OF SUMTER COUNTY, FLORIDA: RUN SOUTHWESTERLY ALONG THE ARC

OF SAID CURVE, THROUGH A CENTRAL ANGLE OF  $09^{\circ}48'16''$ , AN ARC DISTANCE OF 130.05 FEET TO THE POINT OF REVERSE CURVATURE OF A CURVE CONCAVE NORTHWESTERLY AND HAVING A RADIUS OF 50.25 FEET; THENCE SOUTHWESTERLY ALONG THE ARC OF SAID CURVE THROUGH A CENTRAL ANGLE OF  $47^{\circ}00'26''$ , AN ARC DISTANCE OF 41.23 FEET TO THE POINT OF REVERSE CURVATURE OF A CURVE CONCAVE SOUTHEASTERLY AND HAVING A RADIUS OF 129.75 FEET; THENCE SOUTHWESTERLY ALONG THE ARC OF SAID CURVE THROUGH A CENTRAL ANGLE OF  $44^{\circ}04'57''$ , AN ARC DISTANCE OF 99.83 FEET TO A POINT ON THE ARC OF A NON-TANGENT CURVE CONCAVE NORTHERLY, HAVING A RADIUS OF 87.50 FEET AND A CHORD BEARING AND DISTANCE OF  $N87^{\circ}39'22''W$ , 31.37 FEET TO WHICH A RADIAL LINE BEARS  $S07^{\circ}58'55''E$ ; THENCE WESTERLY ALONG THE ARC OF SAID CURVE, THROUGH A CENTRAL ANGLE OF  $20^{\circ}39'05''$ , AN ARC DISTANCE OF 31.54 FEET TO THE POINT OF TANGENCY; THENCE  $N77^{\circ}19'50''W$ , 41.25 FEET TO THE POINT OF CURVATURE OF A CURVE CONCAVE SOUTHERLY AND HAVING A RADIUS OF 630.00 FEET; THENCE WESTERLY ALONG THE ARC OF SAID CURVE THROUGH A CENTRAL ANGLE OF  $20^{\circ}14'03''$ , AN ARC DISTANCE OF 222.49 FEET TO THE POINT OF TANGENCY; THENCE  $S82^{\circ}26'07''W$ , 147.66 FEET TO THE POINT OF CURVATURE OF A CURVE CONCAVE SOUTHERLY AND HAVING A RADIUS OF 313.09 FEET; THENCE WESTERLY ALONG THE ARC OF SAID CURVE THROUGH A CENTRAL ANGLE OF  $19^{\circ}31'46''$ , AN ARC DISTANCE OF 106.72 FEET TO THE POINT OF REVERSE CURVATURE OF A CURVE CONCAVE NORTHERLY AND HAVING A RADIUS OF 122.50 FEET; THENCE WESTERLY ALONG THE ARC OF SAID CURVE THROUGH A CENTRAL ANGLE OF  $56^{\circ}24'22''$ , AN ARC DISTANCE OF 120.60 FEET TO THE POINT OF REVERSE CURVATURE OF A CURVE CONCAVE SOUTHERLY AND HAVING A RADIUS OF 379.50 FEET; THENCE WESTERLY ALONG THE ARC OF SAID CURVE THROUGH A CENTRAL ANGLE OF  $17^{\circ}36'18''$ , AN ARC DISTANCE OF 116.61 FEET TO THE POINT OF COMPOUND CURVATURE OF A CURVE CONCAVE SOUTHERLY AND HAVING A RADIUS OF 592.50 FEET; THENCE WESTERLY ALONG THE ARC OF SAID CURVE THROUGH A CENTRAL ANGLE OF  $10^{\circ}28'19''$ , AN ARC DISTANCE OF 108.29 FEET TO THE POINT OF REVERSE CURVATURE OF A CURVE CONCAVE NORTHERLY AND HAVING A RADIUS OF 485.50 FEET; THENCE WESTERLY ALONG THE ARC OF SAID CURVE THROUGH A CENTRAL ANGLE OF  $11^{\circ}02'56''$ , AN ARC DISTANCE OF 93.62 FEET; THENCE ALONG A NON-TANGENT LINE RUN  $N02^{\circ}38'27''W$ , 31.43 FEET TO A POINT ON THE ARC OF A NON-TANGENT CURVE CONCAVE NORTHERLY, HAVING A RADIUS OF 235.00 FEET AND A CHORD BEARING AND DISTANCE OF  $N80^{\circ}13'15''W$ , 101.20 FEET TO WHICH A RADIAL LINE BEARS  $S02^{\circ}39'20''E$ ; THENCE WESTERLY ALONG THE ARC OF SAID CURVE, THROUGH A CENTRAL ANGLE OF  $24^{\circ}52'10''$ , AN ARC DISTANCE OF 102.00 FEET TO THE POINT OF TANGENCY; THENCE  $N67^{\circ}47'10''W$ , 247.20 FEET; THENCE  $N24^{\circ}48'19''E$ , 442.03 FEET; THENCE  $N27^{\circ}23'11''E$ , 85.54 FEET TO A POINT ON THE BOUNDARY LINE OF EASEMENT PER OFFICIAL RECORDS BOOK 2973, PAGE 546, PUBLIC RECORDS OF SUMTER COUNTY, FLORIDA; THE FOLLOWING TWO (2) COURSES BEING ALONG SAID BOUNDARY OF EASEMENT: RUN  $N60^{\circ}12'34''E$ , 1.98 FEET; THENCE  $N24^{\circ}48'19''E$ , 23.84 FEET TO THE POINT OF BEGINNING.

EXHIBIT 3

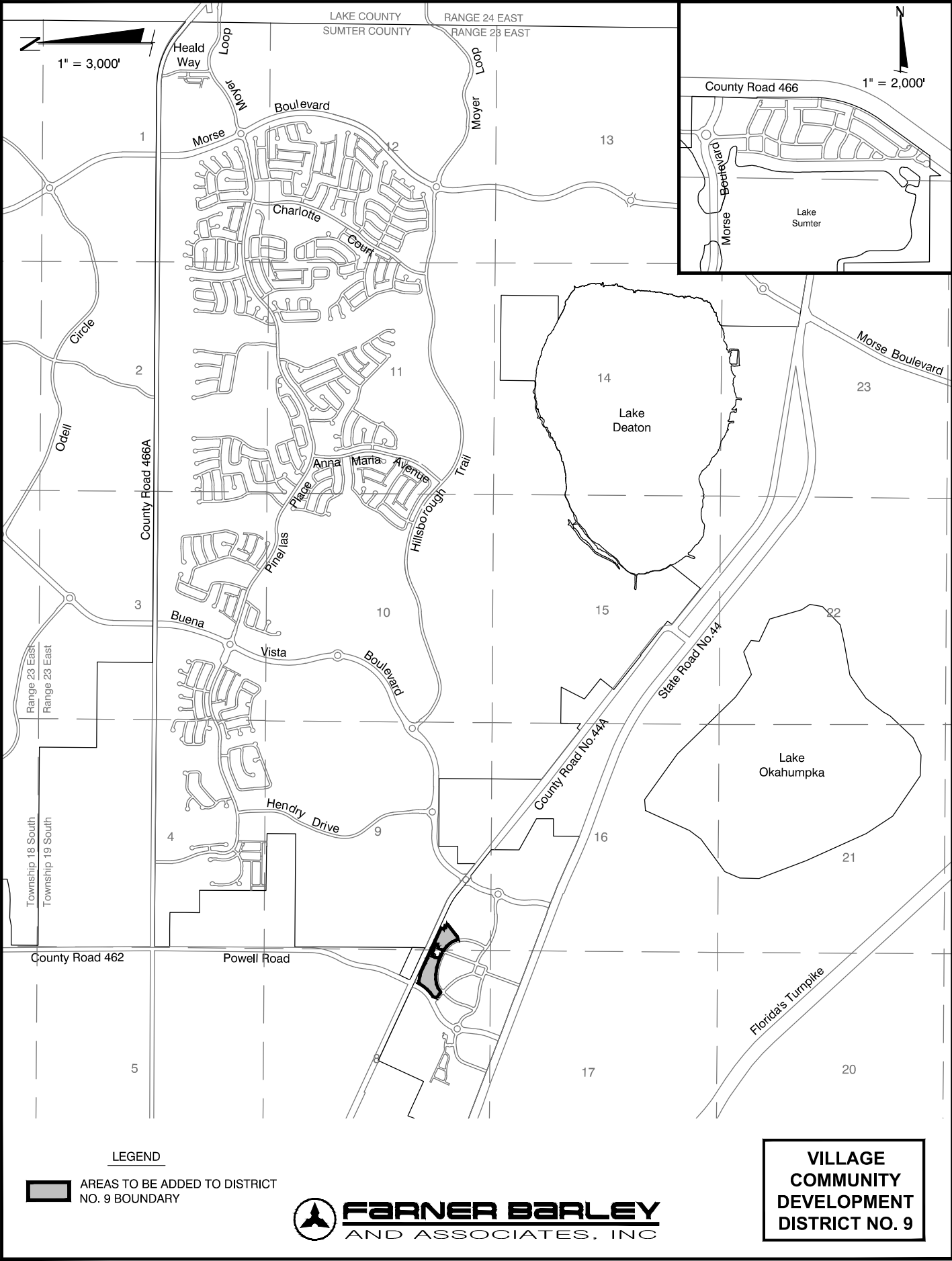

NET AREAS TO BE ADDED TO VILLAGE COMMUNITY DEVELOPMENT DISTRICT NO. 9

## **EXHIBIT "3"**

### **DESCRIPTION OF THE AREA TO BE ADDED TO VILLAGE COMMUNITY DEVELOPMENT DISTRICT NO. 9 APPROXIMATELY 11.1 ACRES**

THOSE PORTIONS OF TRACT 14, TRACT 15 AND BROWNWOOD BOULEVARD, VACATED PER RESOLUTION IN OFFICIAL RECORDS BOOK 3428, PAGE 242, PUBLIC RECORDS OF SUMTER COUNTY, FLORIDA; ALL WITHIN BROWNWOOD DOWNTOWN, ACCORDING TO THE PLAT THEREOF AS RECORDED IN PLAT BOOK 15, PAGES 6, 6A THROUGH 6I, INCLUSIVE, PUBLIC RECORDS OF SUMTER COUNTY, FLORIDA, AND BEING MORE PARTICULARLY DESCRIBED AS FOLLOWS:

BEGIN AT THE MOST SOUTHERLY CORNER OF AFORESAID TRACT 14; THE FOLLOWING THREE (3) COURSES BEING ALONG THE SOUTHERLY BOUNDARY LINES OF AFORESAID TRACT 14 AND BROWNWOOD BOULEVARD; SAID POINT BEING ON A CURVE CONCAVE SOUTHWESTERLY AND HAVING A RADIUS OF 530.00 FEET AND A CHORD BEARING AND DISTANCE OF N24°18'18"W, 231.14 FEET TO WHICH A RADIAL LINE BEARS N78°17'23"E; THENCE NORTHWESTERLY ALONG THE ARC OF SAID CURVE, THROUGH A CENTRAL ANGLE OF 25°11'22", A DISTANCE OF 233.01 FEET TO THE POINT OF COMPOUND CURVATURE OF A CURVE CONCAVE SOUTHWESTERLY AND HAVING A RADIUS OF 580.00 FEET; THENCE NORTHWESTERLY ALONG THE ARC OF SAID CURVE THROUGH A CENTRAL ANGLE OF 22°14'36", AN ARC DISTANCE OF 225.17 FEET TO THE POINT OF COMPOUND CURVATURE OF A CURVE CONCAVE SOUTHERLY AND HAVING A RADIUS OF 1,330.00 FEET; THENCE WESTERLY ALONG THE ARC OF SAID CURVE THROUGH A CENTRAL ANGLE OF 00°49'38", AN ARC DISTANCE OF 19.21 FEET TO A POINT ON THE ARC OF A NON-TANGENT CURVE CONCAVE EASTERLY, HAVING A RADIUS OF 9.33 FEET AND A CHORD BEARING AND DISTANCE OF N18°41'49"E, 1.99 FEET TO WHICH A RADIAL LINE BEARS N77°26'11"W; THENCE DEPARTING SAID SOUTHERLY BOUNDARY LINE RUN NORTHERLY ALONG THE ARC OF SAID CURVE, THROUGH A CENTRAL ANGLE OF 12°15'59", AN ARC DISTANCE OF 2.00 FEET TO THE POINT OF TANGENCY; THENCE N24°49'48"E, 14.85 FEET TO THE POINT OF CURVATURE OF A CURVE CONCAVE SOUTHERLY AND HAVING A RADIUS OF 1.33 FEET; THENCE EASTERLY ALONG THE ARC OF SAID CURVE THROUGH A CENTRAL ANGLE OF 90°00'00", AN ARC DISTANCE OF 2.09 FEET TO THE POINT OF TANGENCY; THENCE S65°10'12"E, 14.00 FEET; THENCE N24°49'48"E, 113.31 FEET TO A POINT ON THE ARC OF A NON-TANGENT CURVE CONCAVE NORTHWESTERLY, HAVING A RADIUS OF 60.67 FEET AND A CHORD BEARING AND DISTANCE OF N66°44'13"E, 54.81 FEET TO WHICH A RADIAL LINE BEARS S03°35'24"W; THENCE NORTHEASTERLY ALONG THE ARC OF SAID CURVE, THROUGH A CENTRAL ANGLE OF 53°42'21", AN ARC DISTANCE OF 56.87 FEET; THENCE ALONG A NON-TANGENT LINE RUN N60°43'08"E, 13.66 FEET; THENCE S80°28'44"E, 31.34 FEET; THENCE N09°31'16"E, 55.43 FEET TO A POINT ON THE ARC OF A NON-TANGENT CURVE CONCAVE SOUTHERLY, HAVING A RADIUS OF 50.67 FEET AND A CHORD BEARING AND DISTANCE OF S85°55'38"W, 21.06 FEET TO WHICH A RADIAL LINE BEARS N07°55'24"E; THENCE WESTERLY ALONG THE ARC OF SAID CURVE, THROUGH A CENTRAL ANGLE OF

23°59'33", AN ARC DISTANCE OF 21.22 FEET TO THE POINT OF REVERSE CURVATURE OF A CURVE CONCAVE NORTHEASTERLY AND HAVING A RADIUS OF 29.33 FEET; THENCE NORTHWESTERLY ALONG THE ARC OF SAID CURVE THROUGH A CENTRAL ANGLE OF 79°07'16", AN ARC DISTANCE OF 40.50 FEET TO THE POINT OF REVERSE CURVATURE OF A CURVE CONCAVE SOUTHWESTERLY AND HAVING A RADIUS OF 42.67 FEET; THENCE NORTHWESTERLY ALONG THE ARC OF SAID CURVE THROUGH A CENTRAL ANGLE OF 05°17'46", AN ARC DISTANCE OF 3.94 FEET TO THE POINT OF REVERSE CURVATURE OF A CURVE CONCAVE EASTERLY AND HAVING A RADIUS OF 19.33 FEET; THENCE NORTHERLY ALONG THE ARC OF SAID CURVE THROUGH A CENTRAL ANGLE OF 57°04'26", AN ARC DISTANCE OF 19.26 FEET TO THE POINT OF TANGENCY; THENCE N24°49'48"E, 3.74 FEET; THENCE N20°33'38"E, 13.61 FEET TO THE NORTHERLY BOUNDARY LINE OF AFORESAID BROWNWOOD BOULEVARD; THENCE ALONG SAID NORTHERLY BOUNDARY LINE RUN S65°10'12"E, 11.62 FEET TO THE MOST NORTHERLY CORNER OF AFORESAID TRACT 15; THE FOLLOWING TWO (2) COURSES BEING ALONG THE BOUNDARY LINES OF SAID TRACT 15: RUN S65°09'28"E, 78.29 FEET; THENCE S24°50'32"W, 2.25 FEET TO A POINT ON THE BOUNDARY OF AFORESAID TRACT 14; THE FOLLOWING SEVEN (7) COURSES BEING ALONG THE BOUNDARY LINES OF SAID TRACT 14: RUN S65°09'28"E, 371.50 FEET; THENCE S24°45'38"W, 60.69 FEET; THENCE S65°29'03"E, 66.30 FEET; THENCE S18°16'44"W, 23.89 FEET; THENCE S65°11'44"E, 69.17 FEET; THENCE S37°05'23"W, 27.42 FEET; THENCE S51°58'15"W, 422.27 FEET TO THE POINT OF BEGINNING.

AND:

THOSE PORTIONS OF TRACT 9, TRACT 13 AND BROWNWOOD BOULEVARD, VACATED PER RESOLUTION IN OFFICIAL RECORDS BOOK 3428, PAGE 242, PUBLIC RECORDS OF SUMTER COUNTY, FLORIDA; ALL WITHIN BROWNWOOD DOWNTOWN, ACCORDING TO THE PLAT THEREOF AS RECORDED IN PLAT BOOK 15, PAGES 6, 6A THROUGH 6I, INCLUSIVE, PUBLIC RECORDS OF SUMTER COUNTY, FLORIDA, AND BEING MORE PARTICULARLY DESCRIBED AS FOLLOWS:

COMMENCE AT THE MOST SOUTHERLY CORNER OF TRACT 14, BROWNWOOD DOWNTOWN, ACCORDING TO THE PLAT THEREOF AS RECORDED IN PLAT BOOK 15, PAGES 6, 6A THROUGH 6I, INCLUSIVE, PUBLIC RECORDS OF SUMTER COUNTY, FLORIDA; THE FOLLOWING TWENTY-FIVE (25) COURSES BEING ALONG THE SOUTHERLY, WESTERLY AND NORTHERLY BOUNDARY LINES, RESPECTIVELY, OF AFORESAID TRACT 14, BROWNWOOD BOULEVARD AND TRACT 9; SAID POINT BEING ON A CURVE CONCAVE SOUTHWESTERLY AND HAVING A RADIUS OF 530.00 FEET AND A CHORD BEARING AND DISTANCE OF N24°18'18"W, 231.14 FEET TO WHICH A RADIAL LINE BEARS N78°17'23"E; THENCE NORTHWESTERLY ALONG THE ARC OF SAID CURVE, THROUGH A CENTRAL ANGLE OF 25°11'22", A DISTANCE OF 233.01 FEET TO THE POINT OF COMPOUND CURVATURE OF A CURVE CONCAVE SOUTHWESTERLY AND HAVING A RADIUS OF 580.00 FEET; THENCE NORTHWESTERLY ALONG THE ARC OF SAID CURVE THROUGH A CENTRAL ANGLE OF 22°14'36", AN ARC DISTANCE OF 225.17 FEET TO THE POINT OF COMPOUND CURVATURE OF A CURVE CONCAVE SOUTHERLY AND HAVING A RADIUS OF 1,330.00 FEET;

THENCE WESTERLY ALONG THE ARC OF SAID CURVE THROUGH A CENTRAL ANGLE OF 02°10'41", AN ARC DISTANCE OF 50.56 FEET TO THE POINT OF BEGINNING; THENCE CONTINUE WESTERLY ALONG SAID CURVE THROUGH A CENTRAL ANGLE OF 23°20'40", A DISTANCE OF 541.89 FEET TO A POINT OF COMPOUND CURVATURE OF A CURVE CONCAVE SOUTHERLY AND HAVING A RADIUS OF 675.00 FEET; THENCE WESTERLY ALONG THE ARC OF SAID CURVE THROUGH A CENTRAL ANGLE OF 18°42'28", AN ARC DISTANCE OF 220.40 FEET TO A POINT OF COMPOUND CURVATURE OF A CURVE CONCAVE SOUTHEASTERLY AND HAVING A RADIUS OF 395.00 FEET; THENCE SOUTHWESTERLY ALONG THE ARC OF SAID CURVE THROUGH A CENTRAL ANGLE OF 28°56'16", AN ARC DISTANCE OF 199.50 FEET TO THE POINT OF REVERSE CURVATURE OF A CURVE CONCAVE NORTHERLY AND HAVING A RADIUS OF 25.00 FEET; THENCE WESTERLY ALONG THE ARC OF SAID CURVE THROUGH A CENTRAL ANGLE OF 83°29'34", AN ARC DISTANCE OF 36.43 FEET TO THE POINT OF REVERSE CURVATURE OF A CURVE CONCAVE SOUTHWESTERLY AND HAVING A RADIUS OF 530.00 FEET; THENCE NORTHWESTERLY ALONG THE ARC OF SAID CURVE THROUGH A CENTRAL ANGLE OF 04°05'19", AN ARC DISTANCE OF 37.82 FEET TO THE POINT OF TANGENCY; THENCE N52°54'25"W, 59.10 FEET TO THE POINT OF CURVATURE OF A CURVE CONCAVE NORTHEASTERLY AND HAVING A RADIUS OF 270.00 FEET; THENCE NORTHWESTERLY ALONG THE ARC OF SAID CURVE THROUGH A CENTRAL ANGLE OF 05°48'53", AN ARC DISTANCE OF 27.40 FEET; THENCE ALONG A NON-TANGENT LINE RUN N43°58'08"E, 5.00 FEET TO A POINT ON THE ARC OF A NON-TANGENT CURVE CONCAVE NORTHEASTERLY, HAVING A RADIUS OF 265.00 FEET AND A CHORD BEARING AND DISTANCE OF N43°59'27"W, 28.86 FEET TO WHICH A RADIAL LINE BEARS S42°53'16"W; THENCE NORTHWESTERLY ALONG THE ARC OF SAID CURVE, THROUGH A CENTRAL ANGLE OF 06°14'35", AN ARC DISTANCE OF 28.88 FEET; THENCE ALONG A NON-TANGENT LINE RUN N19°35'24"E, 76.10 FEET TO A POINT ON THE ARC OF A NON-TANGENT CURVE CONCAVE NORTHWESTERLY, HAVING A RADIUS OF 857.13 FEET AND A CHORD BEARING AND DISTANCE OF N43°28'42"E, 426.23 FEET TO WHICH A RADIAL LINE BEARS S32°07'28"E; THENCE NORTHEASTERLY ALONG THE ARC OF SAID CURVE, THROUGH A CENTRAL ANGLE OF 28°47'38", AN ARC DISTANCE OF 430.75 FEET; THENCE ALONG A NON-TANGENT LINE RUN N28°48'33"E, 42.66 FEET; THENCE S65°47'44"E, 48.66 FEET TO A POINT ON THE ARC OF A NON-TANGENT CURVE CONCAVE NORTHERLY, HAVING A RADIUS OF 406.78 FEET AND A CHORD BEARING AND DISTANCE OF S80°25'17"E, 104.32 FEET TO WHICH A RADIAL LINE BEARS S16°56'44"W; THENCE EASTERLY ALONG THE ARC OF SAID CURVE, THROUGH A CENTRAL ANGLE OF 14°44'02", AN ARC DISTANCE OF 104.60 FEET; THENCE ALONG A NON-TANGENT LINE RUN S85°47'03"E, 43.75 FEET; THENCE S70°38'45"E, 55.89 FEET; THENCE S65°05'00"E, 225.09 FEET TO A POINT ON THE ARC OF A NON-TANGENT CURVE CONCAVE SOUTHWESTERLY, HAVING A RADIUS OF 199.67 FEET AND A CHORD BEARING AND DISTANCE OF S62°13'59"E, 20.73 FEET TO WHICH A RADIAL LINE BEARS N24°47'28"E; THENCE SOUTHEASTERLY ALONG THE ARC OF SAID CURVE, THROUGH A CENTRAL ANGLE OF 05°57'06", AN ARC DISTANCE OF 20.74 FEET TO THE POINT OF REVERSE CURVATURE OF A CURVE CONCAVE NORTHEASTERLY AND HAVING A RADIUS OF 553.33 FEET; THENCE SOUTHEASTERLY ALONG THE ARC OF SAID CURVE THROUGH A CENTRAL ANGLE OF 11°54'12", AN ARC DISTANCE OF 114.95 FEET TO THE POINT OF REVERSE CURVATURE OF A CURVE CONCAVE SOUTHERLY AND HAVING A RADIUS OF 199.67 FEET;

THENCE EASTERLY ALONG THE ARC OF SAID CURVE THROUGH A CENTRAL ANGLE OF 05°57'06", AN ARC DISTANCE OF 20.74 FEET; THENCE ALONG A NON-TANGENT LINE RUN S65°19'45"E, 54.26 FEET; THENCE S63°26'02"E, 121.72 FEET TO A POINT ON THE BOUNDARY OF AFORESAID TRACT 13; THENCE ALONG SAID BOUNDARY OF TRACT 13 RUN N26°33'58"E, 4.60 FEET; THENCE DEPARTING SAID BOUNDARY RUN S61°25'11"E, 8.00 FEET; THENCE S68°34'55"E, 26.76 FEET; THENCE S70°21'35"E, 18.69 FEET TO A POINT ON THE BOUNDARY OF AFORESAID TRACT 13; THENCE ALONG SAID BOUNDARY RUN S63°26'02"E, 31.78 FEET TO THE NORTHERLY BOUNDARY LINE OF AFORESAID BROWNWOOD BOULEVARD; THENCE ALONG SAID NORTHERLY BOUNDARY LINE RUN S65°10'12"E, 11.53 FEET; THENCE DEPARTING SAID NORTHERLY BOUNDARY LINE RUN S28°12'25"W, 13.60 FEET; THENCE S24°49'48"W, 3.69 FEET TO THE POINT OF CURVATURE OF A CURVE CONCAVE NORTHWESTERLY AND HAVING A RADIUS OF 19.33 FEET; THENCE SOUTHWESTERLY ALONG THE ARC OF SAID CURVE THROUGH A CENTRAL ANGLE OF 57°09'21", AN ARC DISTANCE OF 19.28 FEET TO THE POINT OF REVERSE CURVATURE OF A CURVE CONCAVE SOUTHERLY AND HAVING A RADIUS OF 42.67 FEET; THENCE WESTERLY ALONG THE ARC OF SAID CURVE THROUGH A CENTRAL ANGLE OF 20°33'01", AN ARC DISTANCE OF 15.30 FEET TO THE POINT OF REVERSE CURVATURE OF A CURVE CONCAVE NORTHERLY AND HAVING A RADIUS OF 34.33 FEET; THENCE WESTERLY ALONG THE ARC OF SAID CURVE THROUGH A CENTRAL ANGLE OF 82°50'27", AN ARC DISTANCE OF 49.64 FEET TO THE POINT OF TANGENCY; THENCE N35°43'25"W, 44.21 FEET; THENCE S54°16'35"W, 58.34 FEET; THENCE N35°43'25"W, 14.86 FEET TO THE POINT OF CURVATURE OF A CURVE CONCAVE SOUTHWESTERLY AND HAVING A RADIUS OF 20.00 FEET; THENCE NORTHWESTERLY ALONG THE ARC OF SAID CURVE THROUGH A CENTRAL ANGLE OF 36°15'18", AN ARC DISTANCE OF 12.66 FEET TO THE POINT OF TANGENCY; THENCE N71°58'42"W, 38.02 FEET; THENCE S18°01'18"W, 29.67 FEET; THENCE S71°58'42"E, 20.11 FEET; THENCE S18°01'18"W, 4.59 FEET TO THE POINT OF CURVATURE OF A CURVE CONCAVE NORTHWESTERLY AND HAVING A RADIUS OF 16.55 FEET; THENCE SOUTHWESTERLY ALONG THE ARC OF SAID CURVE THROUGH A CENTRAL ANGLE OF 54°15'55", AN ARC DISTANCE OF 15.68 FEET TO THE POINT OF REVERSE CURVATURE OF A CURVE CONCAVE SOUTHEASTERLY AND HAVING A RADIUS OF 45.94 FEET; THENCE SOUTHWESTERLY ALONG THE ARC OF SAID CURVE THROUGH A CENTRAL ANGLE OF 81°29'18", AN ARC DISTANCE OF 65.33 FEET TO THE POINT OF REVERSE CURVATURE OF A CURVE CONCAVE WESTERLY AND HAVING A RADIUS OF 72.81 FEET; THENCE SOUTHERLY ALONG THE ARC OF SAID CURVE THROUGH A CENTRAL ANGLE OF 33°40'49", AN ARC DISTANCE OF 42.80 FEET; THENCE ALONG A NON-TANGENT LINE RUN S24°11'54"W, 25.94 FEET; THENCE S65°48'02"E, 78.14 FEET; THENCE S24°11'58"W, 4.93 FEET TO THE POINT OF CURVATURE OF A CURVE CONCAVE EASTERLY AND HAVING A RADIUS OF 9.00 FEET; THENCE SOUTHERLY ALONG THE ARC OF SAID CURVE THROUGH A CENTRAL ANGLE OF 90°00'03", AN ARC DISTANCE OF 14.14 FEET TO THE POINT OF TANGENCY; THENCE S65°48'06"E, 68.66 FEET TO THE POINT OF CURVATURE OF A CURVE CONCAVE WESTERLY AND HAVING A RADIUS OF 4.00 FEET; THENCE SOUTHERLY ALONG THE ARC OF SAID CURVE THROUGH A CENTRAL ANGLE OF 94°30'06", AN ARC DISTANCE OF 6.60 FEET; THENCE ALONG A NON-TANGENT LINE RUN S28°40'43"W, 2.15 FEET TO THE POINT OF BEGINNING.

EXHIBIT "4"

Revised District Map

EXHIBIT 4

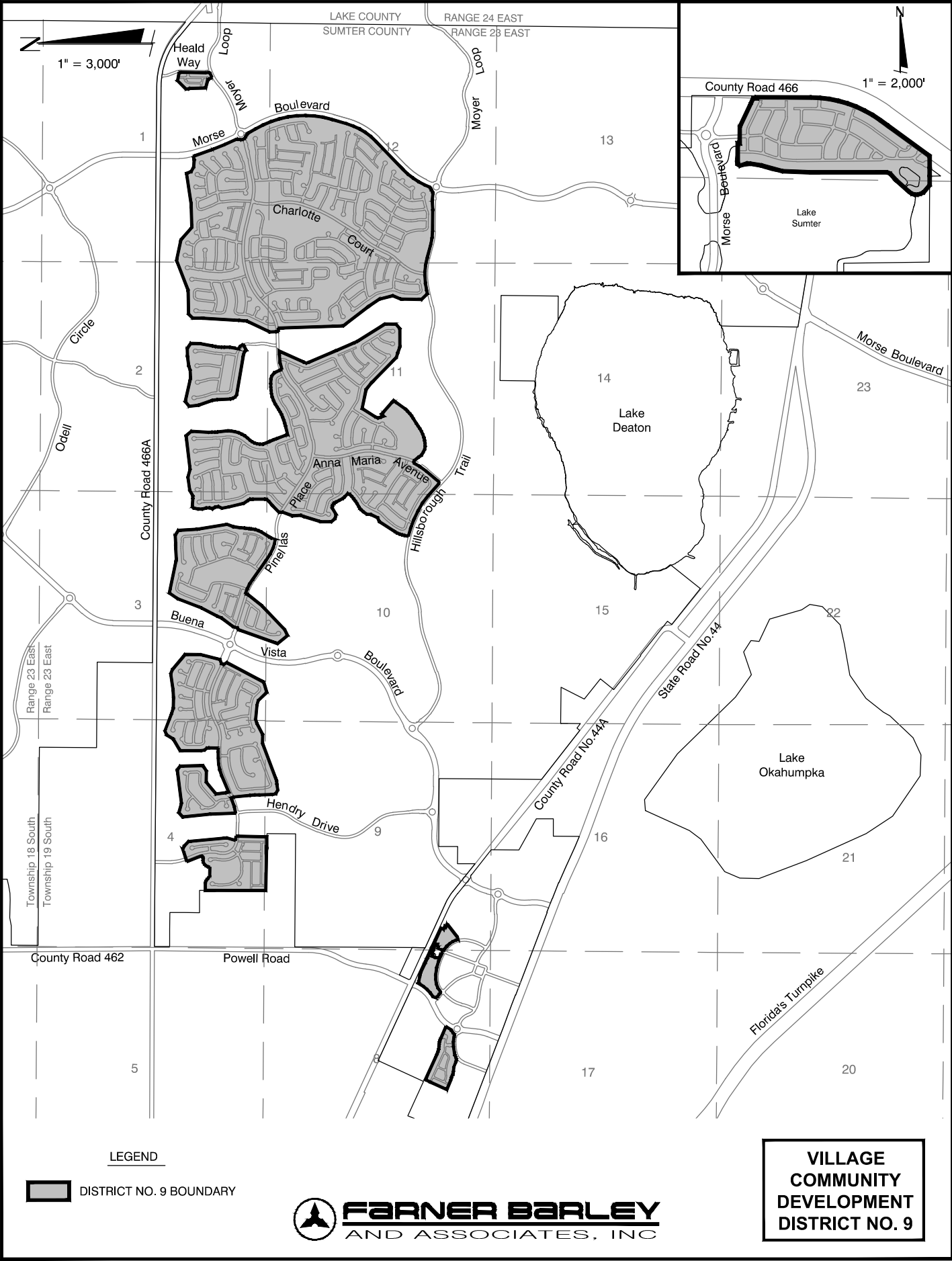

## **EXHIBIT "4"**

### **DESCRIPTION OF THE AMENDED VILLAGE COMMUNITY DEVELOPMENT DISTRICT NO. 9 APPROXIMATELY 1309.8 ACRES**

THAT LAND LYING IN SECTIONS 1, 2, 11 AND 12, TOWNSHIP 19 SOUTH, RANGE 23 EAST, SUMTER COUNTY, FLORIDA, DESCRIBED AS FOLLOWS:

FROM THE SOUTHEAST CORNER OF THE SOUTHEAST 1/4 OF SAID SECTION 2 RUN N00°28'41"E, ALONG THE EAST LINE THEREOF A DISTANCE OF 579.09 FEET; THENCE DEPARTING SAID EAST LINE, N89°31'19"W, 1,314.06 FEET TO THE POINT OF BEGINNING; THENCE N05°37'01"E, 64.18 FEET; THENCE N03°23'36"E, 965.29 FEET; THENCE N00°27'12"E, 224.33 FEET; THENCE N44°31'02"E, 136.96 FEET; THENCE N88°34'52"E, 552.22 FEET; THENCE N68°52'57"E, 747.55 FEET; THENCE S77°33'55"E, 490.96 FEET; THENCE S48°28'04"E, 378.86 FEET; THENCE N88°17'40"E, 541.22 FEET; THENCE N81°33'50"E, 727.04 FEET; THENCE S21°20'47"E, 114.32 FEET; THENCE S60°37'44"E, 117.99 FEET; THENCE S84°52'44"E, 113.69 FEET; THENCE N89°54'48"E, 77.13 FEET; THENCE N72°17'25"E, 60.03 FEET TO A POINT ON THE ARC OF A CURVE CONCAVE EASTERLY, HAVING A RADIUS OF 6,084.00 FEET AND A CHORD BEARING AND DISTANCE OF S19°53'41"E, 463.88 FEET; THENCE SOUTHERLY ALONG THE ARC OF SAID CURVE, THROUGH A CENTRAL ANGLE OF 04°22'11", A DISTANCE OF 464.00 FEET TO THE POINT OF REVERSE CURVATURE OF A CURVE CONCAVE WESTERLY AND HAVING A RADIUS OF 500.00 FEET; THENCE SOUTHERLY ALONG THE ARC OF SAID CURVE THROUGH A CENTRAL ANGLE OF 01°53'03", A DISTANCE OF 16.44 FEET TO THE POINT OF REVERSE CURVATURE OF A CURVE CONCAVE NORTHEASTERLY AND HAVING A RADIUS OF 6,060.00 FEET; THENCE SOUTHEASTERLY ALONG THE ARC OF SAID CURVE THROUGH A CENTRAL ANGLE OF 05°36'01", A DISTANCE OF 592.31 FEET TO THE POINT OF REVERSE CURVATURE OF A CURVE CONCAVE WESTERLY AND HAVING A RADIUS OF 75.00 FEET; THENCE SOUTHERLY ALONG THE ARC OF SAID CURVE THROUGH A CENTRAL ANGLE OF 48°19'26", A DISTANCE OF 63.26 FEET TO THE POINT OF REVERSE CURVATURE OF A CURVE CONCAVE NORTHEASTERLY AND HAVING A RADIUS OF 131.00 FEET; THENCE SOUTHEASTERLY ALONG THE ARC OF SAID CURVE THROUGH A CENTRAL ANGLE OF 99°35'12", A DISTANCE OF 227.69 FEET TO THE POINT OF REVERSE CURVATURE OF A CURVE CONCAVE SOUTHWESTERLY AND HAVING A RADIUS OF 75.00 FEET; THENCE SOUTHEASTERLY ALONG THE ARC OF SAID CURVE THROUGH A CENTRAL ANGLE OF 48°19'26", A DISTANCE OF 63.26 FEET TO THE POINT OF REVERSE CURVATURE OF A CURVE CONCAVE NORTHEASTERLY AND HAVING A RADIUS OF 6,060.00 FEET; THENCE SOUTHEASTERLY ALONG THE ARC OF SAID CURVE THROUGH A CENTRAL ANGLE OF 01°55'56", A DISTANCE OF 204.38 FEET TO THE POINT OF REVERSE CURVATURE OF A CURVE CONCAVE WESTERLY AND HAVING A RADIUS OF 2,240.00 FEET; THENCE SOUTHERLY ALONG THE ARC OF SAID CURVE THROUGH A CENTRAL ANGLE OF 47°03'04", A DISTANCE OF 1,839.48 FEET; THENCE S16°23'04"W, 364.83 FEET TO THE POINT OF CURVATURE OF A CURVE CONCAVE NORTHWESTERLY AND HAVING A RADIUS OF 1,545.00 FEET; THENCE

SOUTHWESTERLY ALONG THE ARC THEREOF THROUGH A CENTRAL ANGLE OF 29°44'49", A DISTANCE OF 802.14 FEET; THENCE S46°07'53"W, 902.91 FEET TO THE POINT OF CURVATURE OF A CURVE CONCAVE SOUTHEASTERLY AND HAVING A RADIUS OF 1,635.00 FEET; THENCE SOUTHWESTERLY ALONG THE ARC THEREOF THROUGH A CENTRAL ANGLE OF 21°44'11", A DISTANCE OF 620.27 FEET; THENCE S24°23'42"W, 125.69 FEET TO THE POINT OF CURVATURE OF A CURVE CONCAVE NORTHWESTERLY AND HAVING A RADIUS OF 50.00 FEET; THENCE SOUTHWESTERLY ALONG THE ARC THEREOF THROUGH A CENTRAL ANGLE OF 52°31'28", A DISTANCE OF 45.84 FEET TO THE POINT OF REVERSE CURVATURE OF A CURVE CONCAVE SOUTHEASTERLY AND HAVING A RADIUS OF 131.00 FEET; THENCE SOUTHWESTERLY ALONG THE ARC OF SAID CURVE THROUGH A CENTRAL ANGLE OF 33°28'01", A DISTANCE OF 76.52 FEET TO THE POINT OF REVERSE CURVATURE OF A CURVE CONCAVE NORTHERLY AND HAVING A RADIUS OF 50.00 FEET; THENCE WESTERLY ALONG THE ARC OF SAID CURVE THROUGH A CENTRAL ANGLE OF 56°24'29", A DISTANCE OF 49.23 FEET TO A POINT ON THE ARC OF A CURVE CONCAVE SOUTHERLY, HAVING A RADIUS OF 951.57 FEET AND A CHORD BEARING AND DISTANCE OF N85°06'45"W, 164.29 FEET; THENCE WESTERLY ALONG THE ARC OF SAID CURVE, THROUGH A CENTRAL ANGLE OF 09°54'16", A DISTANCE OF 164.50 FEET TO A POINT ON THE ARC OF A CURVE CONCAVE SOUTHERLY, HAVING A RADIUS OF 257.00 FEET AND A CHORD BEARING AND DISTANCE OF S88°43'58"W, 16.39 FEET; THENCE WESTERLY ALONG THE ARC OF SAID CURVE, THROUGH A CENTRAL ANGLE OF 03°39'13", A DISTANCE OF 16.39 FEET; THENCE S86°54'22"W, 195.81 FEET; THENCE N89°26'26"W, 515.43 FEET TO THE POINT OF CURVATURE OF A CURVE CONCAVE NORTHERLY AND HAVING A RADIUS OF 1,170.00 FEET; THENCE WESTERLY ALONG THE ARC THEREOF THROUGH A CENTRAL ANGLE OF 14°25'28", A DISTANCE OF 294.55 FEET; THENCE N75°00'58"W, 336.64 FEET TO THE POINT OF CURVATURE OF A CURVE CONCAVE SOUTHERLY AND HAVING A RADIUS OF 1,530.00 FEET; THENCE WESTERLY ALONG THE ARC THEREOF THROUGH A CENTRAL ANGLE OF 28°33'23", A DISTANCE OF 762.56 FEET; THENCE S76°25'39"W, 76.46 FEET; THENCE N43°45'02"W, 197.22 FEET; THENCE N01°26'35"E, 481.01 FEET; THENCE N22°24'01"E, 199.74 FEET; THENCE N14°18'44"W, 322.92 FEET; THENCE N33°33'44"W, 284.70 FEET; THENCE N37°35'50"W, 762.86 FEET; THENCE N01°52'00"W, 1,514.01 FEET TO A POINT ON THE ARC OF A CURVE CONCAVE NORTHERLY, HAVING A RADIUS OF 1,030.00 FEET AND A CHORD BEARING AND DISTANCE OF S83°25'10"W, 81.30 FEET; THENCE WESTERLY ALONG THE ARC OF SAID CURVE, THROUGH A CENTRAL ANGLE OF 04°31'26", A DISTANCE OF 81.33 FEET; THENCE N04°19'07"W, 60.00 FEET; THENCE N01°20'38"W, 143.27 FEET; THENCE N25°11'55"E, 594.57 FEET TO THE POINT OF BEGINNING.

AND

THAT LAND LYING IN SECTION 2, TOWNSHIP 19 SOUTH, RANGE 23 EAST, SUMTER COUNTY, FLORIDA, DESCRIBED AS FOLLOWS:

FROM THE SOUTHWEST CORNER OF THE SOUTHEAST 1/4 OF SAID SECTION 2 RUN S89°28'14"E, ALONG THE SOUTH LINE THEREOF A DISTANCE OF 555.97 FEET;

THENCE DEPARTING SAID SOUTH LINE, N00°31'46"E, 641.12 FEET TO THE POINT OF BEGINNING; THENCE N80°12'32"W, 966.06 FEET; THENCE N53°14'46"W, 54.40 FEET; THENCE N31°06'53"W, 60.08 FEET; THENCE N18°10'23"W, 62.33 FEET; THENCE N01°54'15"W, 311.74 FEET; THENCE N09°25'59"W, 105.94 FEET; THENCE N19°25'39"W, 349.63 FEET; THENCE N06°04'24"W, 217.95 FEET; THENCE N50°58'18"E, 143.37 FEET; THENCE S77°03'48"E, 555.54 FEET; THENCE N87°41'44"E, 189.20 FEET; THENCE N70°10'02"E, 97.86 FEET; THENCE N82°40'11"E, 224.40 FEET; THENCE N88°55'59"E, 192.26 FEET; THENCE S55°12'04"E, 137.27 FEET; THENCE S01°01'44"W, 214.13 FEET; THENCE S10°31'15"W, 301.40 FEET; THENCE S10°27'51"W, 69.66 FEET; THENCE S08°02'16"W, 68.07 FEET; THENCE S04°22'29"W, 68.07 FEET; THENCE S00°58'46"W, 68.82 FEET; THENCE S00°18'00"W, 124.60 FEET; THENCE S09°47'28"W, 202.88 FEET TO A POINT ON THE ARC OF A CURVE CONCAVE SOUTHWESTERLY, HAVING A RADIUS OF 275.00 FEET AND A CHORD BEARING AND DISTANCE OF S43°39'41"E, 152.38 FEET; THENCE SOUTHEASTERLY ALONG THE ARC OF SAID CURVE, THROUGH A CENTRAL ANGLE OF 32°10'10", A DISTANCE OF 154.40 FEET; THENCE S62°25'25"W, 160.00 FEET; THENCE N41°23'55"W, 54.95 FEET; THENCE N69°12'45"W, 56.43 FEET TO THE POINT OF BEGINNING.

AND

THAT LAND LYING IN SECTIONS 2, 3, 10 AND 11, TOWNSHIP 19 SOUTH, RANGE 23 EAST, SUMTER COUNTY, FLORIDA, DESCRIBED AS FOLLOWS:

FROM THE NORTHEAST CORNER OF THE NORTHEAST 1/4 OF SAID SECTION 10 RUN S00°40'50"W, ALONG THE EAST LINE THEREOF A DISTANCE OF 294.91 FEET; THENCE DEPARTING SAID EAST LINE, N89°19'10"W, 457.38 FEET TO THE POINT OF BEGINNING; THENCE N07°24'44"W, 74.47 FEET; THENCE N45°46'15"E, 222.64 FEET; THENCE N49°01'45"E, 140.00 FEET; THENCE N44°00'29"E, 54.87 FEET; THENCE N09°11'06"E, 48.86 FEET; THENCE N00°07'40"W, 280.00 FEET; THENCE N02°56'01"W, 60.57 FEET; THENCE N27°27'57"W, 55.10 FEET; THENCE N34°39'04"W, 122.13 FEET; THENCE N13°22'35"W, 369.23 FEET; THENCE N10°19'03"W, 149.93 FEET; THENCE N23°05'27"E, 90.92 FEET; THENCE N08°59'29"W, 76.25 FEET; THENCE N31°56'01"W, 74.23 FEET; THENCE N19°24'07"E, 74.93 FEET; THENCE N04°42'23"W, 73.10 FEET; THENCE N15°05'25"W, 93.65 FEET; THENCE N00°01'07"E, 94.72 FEET; THENCE N12°45'30"E, 105.66 FEET; THENCE N34°51'18"E, 45.21 FEET; THENCE S86°30'43"E, 196.76 FEET; THENCE S89°15'25"E, 59.80 FEET; THENCE N61°14'05"E, 146.94 FEET; THENCE N82°23'34"E, 314.00 FEET; THENCE S75°05'29"E, 184.12 FEET; THENCE N83°23'49"E, 788.23 FEET; THENCE S40°03'37"E, 158.59 FEET; THENCE S03°03'20"W, 408.59 FEET; THENCE S00°41'28"E, 70.00 FEET; THENCE S02°06'58"E, 67.54 FEET; THENCE S05°35'03"E, 69.03 FEET; THENCE S05°51'07"E, 228.17 FEET; THENCE S02°47'32"W, 87.83 FEET; THENCE S09°33'14"W, 87.78 FEET; THENCE S16°46'38"W, 87.72 FEET; THENCE S23°45'20"W, 81.84 FEET; THENCE S30°29'30"W, 78.75 FEET; THENCE S37°06'20"W, 81.81 FEET; THENCE S43°04'19"W, 74.75 FEET; THENCE S35°36'02"W, 63.66 FEET; THENCE S26°35'09"W, 63.66 FEET; THENCE S17°34'16"W, 63.66 FEET; THENCE S08°33'22"W, 63.66 FEET; THENCE S01°07'05"E, 72.94 FEET; THENCE S22°13'09"E, 159.25 FEET; THENCE S23°00'10"E, 107.25 FEET; THENCE S20°22'53"E, 301.08 FEET; THENCE

S14°21'25"E, 46.45 FEET; THENCE N75°38'35"E, 210.00 FEET; THENCE N75°37'04"E, 69.70 FEET; THENCE N73°18'09"E, 73.78 FEET; THENCE N69°30'44"E, 72.40 FEET; THENCE N65°53'01"E, 67.55 FEET; THENCE N62°22'50"E, 67.55 FEET; THENCE N58°52'39"E, 67.55 FEET; THENCE N56°54'25"E, 69.84 FEET; THENCE N56°56'44"E, 75.59 FEET; THENCE N63°11'51"E, 91.33 FEET; THENCE N71°00'48"E, 91.34 FEET; THENCE N77°13'41"E, 80.89 FEET; THENCE N82°52'29"E, 76.71 FEET; THENCE N85°40'05"E, 75.49 FEET; THENCE N88°48'26"E, 75.49 FEET; THENCE S88°03'00"E, 108.48 FEET; THENCE S74°09'22"E, 72.69 FEET; THENCE S52°40'29"E, 97.54 FEET; THENCE S25°00'11"E, 133.48 FEET; THENCE S19°01'54"E, 60.00 FEET TO A POINT ON THE ARC OF A CURVE CONCAVE SOUTHERLY, HAVING A RADIUS OF 1,170.00 FEET AND A CHORD BEARING AND DISTANCE OF N79°43'11"E, 356.02 FEET; THENCE EASTERLY ALONG THE ARC OF SAID CURVE, THROUGH A CENTRAL ANGLE OF 17°30'10", A DISTANCE OF 357.41 FEET; THENCE N88°28'16"E, 81.88 FEET; THENCE S24°03'38"W, 633.16 FEET; THENCE S22°55'10"W, 61.76 FEET; THENCE S17°27'05"E, 52.91 FEET; THENCE S23°19'37"E, 1226.65 FEET; THENCE S32°04'29"E, 769.09 FEET; THENCE S01°08'06"W, 257.53 FEET; THENCE S49°38'02"W, 137.76 FEET; THENCE N89°36'47"W, 423.95 FEET; THENCE N71°05'11"W, 147.22 FEET; THENCE N73°32'42"W, 108.43 FEET; THENCE N45°34'06"W, 831.88 FEET; THENCE N50°49'53"W, 193.05 FEET; THENCE N78°07'02"W, 451.93 FEET; THENCE S32°43'19"W, 373.47 FEET; THENCE S24°16'56"W, 58.39 FEET; THENCE S19°06'42"E, 140.84 FEET; THENCE N46°59'04"E, 69.76 FEET; THENCE S48°38'51"E, 45.63 FEET; THENCE S48°16'04"E, 372.14 FEET; THENCE S36°38'28"W, 51.56 FEET; THENCE S46°43'20"E, 2.04 FEET; THENCE S36°13'29"W, 287.37 FEET; THENCE S43°47'00"W, 70.00 FEET; THENCE S44°32'16"W, 79.50 FEET; THENCE S53°08'44"W, 66.52 FEET; THENCE S57°49'28"W, 70.00 FEET; THENCE S57°46'45"W, 140.77 FEET; THENCE S56°33'35"W, 71.58 FEET; THENCE S56°17'10"W, 69.60 FEET; THENCE S59°49'21"W, 68.22 FEET; THENCE S65°18'02"W, 79.91 FEET; THENCE S71°14'49"W, 80.88 FEET; THENCE S76°45'39"W, 68.22 FEET; THENCE S81°46'16"W, 68.54 FEET; THENCE S84°59'18"W, 67.88 FEET; THENCE N80°19'26"W, 72.26 FEET; THENCE N63°07'40"W, 74.93 FEET; THENCE N59°48'05"W, 82.33 FEET; THENCE N34°10'54"W, 86.47 FEET; THENCE N38°15'14"W, 118.83 FEET; THENCE N64°36'25"W, 60.00 FEET TO A POINT ON THE ARC OF A CURVE CONCAVE NORTHWESTERLY, HAVING A RADIUS OF 1,370.00 FEET AND A CHORD BEARING AND DISTANCE OF S32°44'33"W, 350.51 FEET; THENCE SOUTHWESTERLY ALONG THE ARC OF SAID CURVE, THROUGH A CENTRAL ANGLE OF 14°41'57", A DISTANCE OF 351.47 FEET; THENCE S40°05'32"W, 402.38 FEET TO THE POINT OF CURVATURE OF A CURVE CONCAVE NORTHERLY AND HAVING A RADIUS OF 20.00 FEET; THENCE WESTERLY ALONG THE ARC THEREOF THROUGH A CENTRAL ANGLE OF 92°11'55", A DISTANCE OF 32.18 FEET; THENCE N47°42'33"W, 388.21 FEET TO THE POINT OF CURVATURE OF A CURVE CONCAVE SOUTHWESTERLY AND HAVING A RADIUS OF 1,130.00 FEET; THENCE NORTHWESTERLY ALONG THE ARC THEREOF THROUGH A CENTRAL ANGLE OF 10°32'43", A DISTANCE OF 207.98 FEET TO THE POINT OF COMPOUND CURVATURE OF A CURVE CONCAVE SOUTHWESTERLY AND HAVING A RADIUS OF 2,841.98 FEET; THENCE NORTHWESTERLY ALONG THE ARC OF SAID CURVE THROUGH A CENTRAL ANGLE OF 17°07'36", A DISTANCE OF 849.52 FEET; THENCE N12°17'59"E, 88.76 FEET; THENCE N12°36'30"E, 59.94 FEET; THENCE N18°40'59"E, 59.20 FEET; THENCE N21°06'14"E, 59.97 FEET; THENCE N31°55'32"E, 60.02 FEET; THENCE N32°47'36"E, 439.51 FEET; THENCE

N66°34'01"E, 95.01 FEET; THENCE N26°17'58"E, 178.55 FEET; THENCE N00°51'57"E, 85.87 FEET; THENCE N35°11'04"E, 101.48 FEET; THENCE N40°40'33"E, 108.17 FEET; THENCE N63°26'38"E, 55.61 FEET; THENCE N59°23'00"E, 83.20 FEET; THENCE N56°52'44"E, 68.74 FEET; THENCE N53°16'59"E, 68.74 FEET; THENCE N49°41'14"E, 68.74 FEET; THENCE N46°46'33"E, 67.90 FEET; THENCE N22°13'04"E, 50.41 FEET; THENCE N46°36'13"W, 106.90 FEET; THENCE N42°34'34"W, 54.47 FEET; THENCE N27°54'37"W, 180.13 FEET; THENCE N28°46'29"W, 49.94 FEET; THENCE N41°06'56"W, 24.44 FEET; THENCE N63°31'39"W, 32.36 FEET; THENCE N73°20'53"W, 30.40 FEET; THENCE N81°58'28"W, 35.90 FEET; THENCE S58°45'12"W, 182.61 FEET; THENCE N74°18'37"W, 98.00 FEET; THENCE N39°43'09"W, 113.15 FEET; THENCE N00°05'37"W, 241.03 FEET; THENCE N16°59'44"E, 426.28 FEET; THENCE N21°52'52"E, 69.32 FEET; THENCE N04°12'39"W, 188.28 FEET; THENCE N20°19'10"E, 253.15 FEET TO THE POINT OF BEGINNING.

AND

THAT LAND LYING IN SECTIONS 3 AND 10, TOWNSHIP 19 SOUTH, RANGE 23 EAST, SUMTER COUNTY, FLORIDA, DESCRIBED AS FOLLOWS:

FROM THE NORTHWEST CORNER OF THE NORTHEAST 1/4 OF SAID SECTION 10 RUN S89°24'14"E, ALONG THE NORTH LINE THEREOF A DISTANCE OF 271.37 FEET; THENCE DEPARTING SAID NORTH LINE, N00°35'46"E, 489.36 FEET TO THE POINT OF BEGINNING; THENCE S38°40'56"W, 415.88 FEET; THENCE S46°13'31"W, 778.48 FEET; THENCE S65°44'56"W, 143.59 FEET; THENCE N39°05'25"W, 297.58 FEET; THENCE N19°35'33"E, 964.92 FEET; THENCE N58°21'40"E, 49.11 FEET; THENCE N14°30'39"E, 100.15 FEET; THENCE N37°16'30"E, 342.23 FEET; THENCE N21°43'18"E, 95.37 FEET; THENCE N27°17'34"E, 430.23 FEET; THENCE N21°11'14"E, 589.13 FEET; THENCE N34°29'35"E, 234.39 FEET; THENCE S78°15'15"E, 795.99 FEET; THENCE N86°31'03"E, 276.93 FEET; THENCE S87°02'16"E, 89.09 FEET; THENCE N86°31'03"E, 201.04 FEET; THENCE S56°59'52"E, 132.02 FEET; THENCE S03°09'20"E, 436.02 FEET; THENCE S09°32'51"E, 708.16 FEET; THENCE S20°58'25"W, 155.84 FEET; THENCE S09°23'10"W, 163.90 FEET; THENCE S02°56'28"W, 95.79 FEET; THENCE S08°37'57"W, 43.32 FEET; THENCE S06°44'50"W, 69.01 FEET; THENCE S04°51'33"W, 40.58 FEET; THENCE S08°03'00"W, 104.00 FEET; THENCE S20°01'39"W, 79.21 FEET; THENCE S23°30'47"W, 67.85 FEET; THENCE S32°33'28"W, 228.60 FEET; THENCE S26°48'04"W, 63.87 FEET; THENCE S20°03'04"W, 80.18 FEET TO A POINT ON THE ARC OF A CURVE CONCAVE NORTHERLY, HAVING A RADIUS OF 670.00 FEET AND A CHORD BEARING AND DISTANCE OF N76°03'05"W, 202.04 FEET; THENCE WESTERLY ALONG THE ARC OF SAID CURVE, THROUGH A CENTRAL ANGLE OF 17°20'36", A DISTANCE OF 202.81 FEET TO THE POINT OF COMPOUND CURVATURE OF A CURVE CONCAVE NORTHEASTERLY AND HAVING A RADIUS OF 1,470.00 FEET; THENCE NORTHWESTERLY ALONG THE ARC OF SAID CURVE THROUGH A CENTRAL ANGLE OF 12°52'10", A DISTANCE OF 330.18 FEET; THENCE N54°30'37"W, 545.62 FEET TO THE POINT OF CURVATURE OF A CURVE CONCAVE SOUTHWESTERLY AND HAVING A RADIUS OF 1,230.00 FEET; THENCE NORTHWESTERLY ALONG THE ARC THEREOF THROUGH A CENTRAL ANGLE OF 17°24'45", A DISTANCE OF 373.80 FEET; THENCE S18°04'38"W, 60.00 FEET TO THE POINT OF BEGINNING.

AND

THAT LAND LYING IN SECTIONS 3, 4 AND 9, TOWNSHIP 19 SOUTH, RANGE 23 EAST, SUMTER COUNTY, FLORIDA, DESCRIBED AS FOLLOWS:

FROM THE SOUTHWEST CORNER OF THE SOUTHWEST 1/4 OF SAID SECTION 3 RUN S89°24'01"E, ALONG THE SOUTH LINE THEREOF A DISTANCE OF 357.71 FEET; THENCE DEPARTING SAID SOUTH LINE, N00°35'59"E, 248.43 FEET TO THE POINT OF BEGINNING; THENCE S74°58'16"E, 106.05 FEET; THENCE S43°04'48"E, 274.41 FEET; THENCE N73°42'27"E, 249.54 FEET; THENCE N27°52'02"E, 972.95 FEET; THENCE N32°01'14"W, 86.01 FEET; THENCE N25°31'02"E, 60.00 FEET; THENCE N69°48'33"E, 95.94 FEET; THENCE N14°36'03"E, 462.98 FEET; THENCE N00°24'11"E, 362.75 FEET; THENCE N49°55'41"W, 457.79 FEET; THENCE N67°04'01"W, 105.72 FEET; THENCE S81°31'41"W, 387.38 FEET; THENCE S87°00'33"W, 173.03 FEET; THENCE N88°23'23"W, 240.95 FEET; THENCE N73°20'26"W, 126.53 FEET; THENCE N69°03'49"W, 438.25 FEET; THENCE S67°38'41"W, 106.78 FEET; THENCE S31°03'58"W, 176.13 FEET; THENCE S59°09'55"W, 314.53 FEET; THENCE S00°24'44"W, 489.33 FEET; THENCE S10°39'52"E, 80.46 FEET; THENCE S40°44'37"E, 66.18 FEET; THENCE S11°04'15"E, 53.09 FEET; THENCE S01°58'27"W, 216.72 FEET TO A POINT ON THE ARC OF A CURVE CONCAVE SOUTHERLY, HAVING A RADIUS OF 2,530.00 FEET AND A CHORD BEARING AND DISTANCE OF N89°00'46"W, 87.17 FEET; THENCE WESTERLY ALONG THE ARC OF SAID CURVE, THROUGH A CENTRAL ANGLE OF 01°58'27", A DISTANCE OF 87.18 FEET; THENCE S90°00'00"W, 146.33 FEET TO THE POINT OF CURVATURE OF A CURVE CONCAVE SOUTHERLY AND HAVING A RADIUS OF 1,030.00 FEET; THENCE WESTERLY ALONG THE ARC THEREOF THROUGH A CENTRAL ANGLE OF 22°43'26", A DISTANCE OF 408.51 FEET; THENCE S67°16'34"W, 422.92 FEET; THENCE N13°12'22"W, 69.88 FEET; THENCE N07°14'07"W, 228.09 FEET; THENCE N50°28'19"E, 359.32 FEET; THENCE S88°16'46"E, 258.18 FEET; THENCE N55°35'39"E, 150.02 FEET; THENCE N01°13'34"W, 529.02 FEET; THENCE N52°33'49"W, 109.22 FEET; THENCE S82°59'08"W, 789.23 FEET; THENCE N74°52'19"W, 222.42 FEET; THENCE S49°22'39"W, 131.66 FEET; THENCE S06°08'46"E, 661.96 FEET; THENCE S01°56'44"E, 578.55 FEET TO A POINT ON THE ARC OF A CURVE CONCAVE NORTHERLY, HAVING A RADIUS OF 1,270.00 FEET AND A CHORD BEARING AND DISTANCE OF N74°14'59"E, 308.39 FEET; THENCE EASTERLY ALONG THE ARC OF SAID CURVE, THROUGH A CENTRAL ANGLE OF 13°56'51", A DISTANCE OF 309.16 FEET; THENCE N67°16'34"E, 60.92 FEET; THENCE S22°43'26"E, 60.00 FEET; THENCE S05°30'41"E, 394.31 FEET; THENCE S04°59'13"E, 98.74 FEET; THENCE S01°41'15"E, 99.23 FEET; THENCE S00°58'38"E, 316.46 FEET; THENCE S12°16'49"E, 77.97 FEET; THENCE S63°14'06"E, 104.23 FEET; THENCE N81°31'46"E, 132.18 FEET; THENCE N86°27'48"E, 74.87 FEET; THENCE N69°34'12"E, 942.93 FEET; THENCE S88°35'57"E, 197.02 FEET; THENCE N62°24'00"E, 296.28 FEET; THENCE N71°41'25"E, 95.78 FEET; THENCE S84°15'10"E, 337.96 FEET TO THE POINT OF BEGINNING.

AND

THAT LAND LYING IN SECTION 4, TOWNSHIP 19 SOUTH, RANGE 23 EAST, SUMTER COUNTY, FLORIDA, DESCRIBED AS FOLLOWS:

FROM THE SOUTHEAST CORNER OF THE SOUTHWEST 1/4 OF SAID SECTION 4 RUN N89°34'47"W, ALONG THE SOUTH LINE THEREOF A DISTANCE OF 77.03 FEET TO THE POINT OF BEGINNING; THENCE CONTINUE ALONG SAID SOUTH LINE N89°34'47"W, 1,249.66 FEET TO THE WEST LINE OF THE SOUTHEAST 1/4 OF THE SOUTHWEST 1/4 OF SAID SECTION 4; THENCE DEPARTING SAID SOUTH LINE, N00°19'22"E, ALONG SAID WEST LINE AND THE NORTHERLY EXTENSION THEREOF A DISTANCE OF 1,422.59 FEET; THENCE DEPARTING SAID LINE, S89°40'38"E, 167.45 FEET; THENCE S74°52'40"E, 50.00 FEET; THENCE S56°21'02"E, 46.82 FEET; THENCE S42°00'12"E, 46.82 FEET; THENCE S23°28'31"E, 19.18 FEET TO A POINT ON THE ARC OF A CURVE CONCAVE NORTHWESTERLY, HAVING A RADIUS OF 170.00 FEET AND A CHORD BEARING AND DISTANCE OF S35°01'12"W, 9.45 FEET; THENCE SOUTHWESTERLY ALONG THE ARC OF SAID CURVE, THROUGH A CENTRAL ANGLE OF 03°11'11", A DISTANCE OF 9.45 FEET; THENCE S89°32'24"E, 249.33 FEET TO A POINT ON THE ARC OF A CURVE CONCAVE SOUTHEASTERLY, HAVING A RADIUS OF 171.00 FEET AND A CHORD BEARING AND DISTANCE OF N54°07'10"E, 259.90 FEET; THENCE NORTHEASTERLY ALONG THE ARC OF SAID CURVE, THROUGH A CENTRAL ANGLE OF 98°54'59", A DISTANCE OF 295.22 FEET TO THE POINT OF REVERSE CURVATURE OF A CURVE CONCAVE NORTHEASTERLY AND HAVING A RADIUS OF 40.00 FEET; THENCE NORTHEASTERLY ALONG THE ARC OF SAID CURVE THROUGH A CENTRAL ANGLE OF 122°10'41", A DISTANCE OF 85.30 FEET TO THE POINT OF REVERSE CURVATURE OF A CURVE CONCAVE SOUTHWESTERLY AND HAVING A RADIUS OF 3,572.15 FEET; THENCE NORTHWESTERLY ALONG THE ARC OF SAID CURVE THROUGH A CENTRAL ANGLE OF 05°38'21", A DISTANCE OF 351.58 FEET; THENCE N72°01'33"E, 298.77 FEET; THENCE S68°33'58"E, 78.77 FEET; THENCE S47°04'11"E, 150.67 FEET; THENCE S05°20'07"E, 898.97 FEET; THENCE S16°39'40"W, 204.79 FEET TO A POINT ON THE ARC OF A CURVE CONCAVE NORTHERLY, HAVING A RADIUS OF 720.00 FEET AND A CHORD BEARING AND DISTANCE OF S81°54'00"E, 103.18 FEET; THENCE EASTERLY ALONG THE ARC OF SAID CURVE, THROUGH A CENTRAL ANGLE OF 08°13'03", A DISTANCE OF 103.26 FEET; THENCE S03°59'29"W, 60.00 FEET; THENCE S01°24'38"W, 656.14 FEET TO THE POINT OF BEGINNING.  
LESS RIGHT-OF-WAY FOR COUNTY ROAD 141.

AND

THAT LAND LYING IN SECTIONS 13 AND 24, TOWNSHIP 18 SOUTH, RANGE 23 EAST, SUMTER COUNTY, FLORIDA, DESCRIBED AS FOLLOWS:

FROM THE NORTH 1/4 CORNER OF SAID SECTION 24 RUN S89°43'44"W, ALONG THE NORTH LINE THEREOF A DISTANCE OF 1,455.08 FEET TO THE SOUTHEAST CORNER OF THE WEST 200.00 FEET OF THE EAST 1/2 OF THE EAST 1/2 OF THE SOUTHWEST 1/4 OF THE SOUTHWEST 1/4 OF SAID SECTION 13 AND THE BOUNDARY OF THE LANDS DESCRIBED IN OFFICIAL RECORDS BOOK 2134, PAGE 376, PUBLIC RECORDS OF SUMTER COUNTY, FLORIDA; THENCE ALONG THE BOUNDARY OF SAID LANDS

DESCRIBED IN OFFICIAL RECORDS BOOK 2134, PAGE 376 THE FOLLOWING COURSES: N00°29'36"E, ALONG EAST LINE OF THE WEST 200.00 FEET OF THE EAST 1/2 OF THE EAST 1/2 OF THE SOUTHWEST 1/4 OF THE SOUTHWEST 1/4 OF SAID SECTION 13 A DISTANCE OF 225.92 FEET TO THE POINT OF BEGINNING; THENCE DEPARTING SAID EAST LINE, N89°26'37"W, 58.96 FEET; THENCE S72°48'01"W, 112.06 FEET; THENCE N55°50'16"W, 41.32 FEET TO THE BOUNDARY OF THE LANDS DESCRIBED IN OFFICIAL RECORDS BOOK 2134, PAGE 380, PUBLIC RECORDS OF SUMTER COUNTY, FLORIDA; THENCE DEPARTING THE LANDS DESCRIBED IN OFFICIAL RECORDS BOOK 2134, PAGE 376, N00°30'19"E, ALONG THE BOUNDARY OF SAID LANDS DESCRIBED IN OFFICIAL RECORDS BOOK 2134, PAGE 380 A DISTANCE OF 324.79 FEET TO THE BOUNDARY OF THE LANDS DESCRIBED IN OFFICIAL RECORDS BOOK 1975, PAGE 151, PUBLIC RECORDS OF SUMTER COUNTY, FLORIDA; THENCE DEPARTING THE BOUNDARY OF SAID LANDS DESCRIBED IN OFFICIAL RECORDS BOOK 2134, PAGE 380 AND ALONG THE BOUNDARY OF SAID LANDS DESCRIBED IN OFFICIAL RECORDS BOOK 1975, PAGE 151 THE FOLLOWING COURSES: S89°29'41"E, 28.17 FEET; THENCE N00°30'19"E, 254.58 FEET; THENCE N25°20'03"E, 408.99 FEET TO THE BOUNDARY OF THE LANDS DESCRIBED IN OFFICIAL RECORDS BOOK 1975, PAGE 145, PUBLIC RECORDS OF SUMTER COUNTY, FLORIDA; THENCE DEPARTING THE BOUNDARY OF SAID LANDS DESCRIBED IN OFFICIAL RECORDS BOOK, 1975, PAGE 151 AND ALONG THE BOUNDARY OF SAID LANDS DESCRIBED IN OFFICIAL RECORDS BOOK 1975, PAGE 145, N22°54'04"E, 42.10 FEET TO A POINT THAT IS 50.00 FEET SOUTH, BY PERPENDICULAR MEASUREMENT, OF THE SOUTHERLY RIGHT-OF-WAY OF C-466; THENCE PARALLEL WITH SAID RIGHT-OF-WAY THE FOLLOWING COURSES: S89°43'03"E, 914.57 FEET TO THE POINT OF CURVATURE OF A CURVE CONCAVE SOUTHERLY AND HAVING A RADIUS OF 1,790.08 FEET; THENCE EASTERLY ALONG THE ARC THEREOF THROUGH A CENTRAL ANGLE OF 35°43'25", A DISTANCE OF 1,116.11 FEET TO THE POINT OF TANGENCY; THENCE S53°59'38"E, 979.60 FEET TO THE EAST LINE OF THE EAST 1/2 OF THE SOUTHWEST 1/4 OF THE SOUTHEAST 1/4 OF SAID SECTION 13; THENCE ALONG SAID EAST LINE, S00°00'22"W, 250.98 FEET TO NORTHEAST CORNER OF THE NORTHWEST 1/4 OF THE NORTHEAST 1/4 OF SAID SECTION 24; THENCE S00°13'04"W, ALONG THE EAST LINE THEREOF A DISTANCE OF 138.69 FEET TO THE BOUNDARY OF SAID LANDS DESCRIBED IN OFFICIAL RECORDS BOOK 2134, PAGE 376; THENCE DEPARTING SAID EAST LINE AND ALONG THE BOUNDARY OF SAID LANDS DESCRIBED IN OFFICIAL RECORDS BOOK 2134, PAGE 376 THE FOLLOWING COURSES: S40°06'00"W, 144.90 FEET; THENCE S65°09'57"W, 52.23 FEET TO THE POINT OF CURVATURE OF A CURVE CONCAVE NORTHERLY AND HAVING A RADIUS OF 160.02 FEET; THENCE WESTERLY ALONG THE ARC THEREOF THROUGH A CENTRAL ANGLE OF 67°05'32", A DISTANCE OF 187.38 FEET TO THE POINT OF TANGENCY; THENCE N47°44'31"W, 279.60 FEET; THENCE N42°20'15"W, 134.30 FEET; THENCE N68°13'17"W, 50.36 FEET TO THE BOUNDARY OF THE LANDS DESCRIBED IN OFFICIAL RECORDS BOOK 2134, PAGE 373, PUBLIC RECORDS OF SUMTER COUNTY, FLORIDA; THENCE S89°54'13"W, 1,203.53 FEET; THENCE N87°27'14"W, 416.39 FEET; THENCE N74°47'41"W, 342.01 FEET; THENCE N80°29'20"W, 167.48 FEET TO THE POINT OF BEGINNING.

AND

A PARCEL OF LAND LYING WITHIN THE SOUTHEAST 1/4 OF SECTION 1, TOWNSHIP 19 SOUTH, RANGE 23 EAST, SUMTER COUNTY, FLORIDA, BEING MORE PARTICULARLY DESCRIBED AS FOLLOWS:

COMMENCE AT THE NORTHEAST CORNER OF THE SOUTHEAST 1/4 OF SAID SECTION 1; THENCE S00°42'50"W ALONG THE EAST LINE OF SAID SOUTHEAST 1/4 A DISTANCE OF 779.55 FEET TO A POINT ON THE SOUTH RIGHT OF WAY LINE OF COUNTY ROAD NUMBER 466A; THENCE ALONG SAID SOUTH RIGHT OF WAY LINE THE FOLLOWING TWO COURSES: N50°52'38"W, 460.37 FEET TO THE POINT OF CURVATURE OF A CURVE CONCAVE SOUTHWESTERLY AND HAVING A RADIUS OF 1835.08 FEET; THENCE NORTHWESTERLY ALONG THE ARC OF SAID CURVE THROUGH A CENTRAL ANGLE OF 00°30'44" FOR A DISTANCE OF 16.40 FEET TO A POINT ON THE BOUNDARY OF THE LANDS DESCRIBED IN OFFICIAL RECORDS BOOK 1811, PAGE 409, PUBLIC RECORDS OF SUMTER COUNTY, FLORIDA; THENCE ALONG SAID BOUNDARY THE FOLLOWING ELEVEN COURSES: DEPARTING SAID SOUTH RIGHT OF WAY LINE RUN S38°42'51"W, 125.45 FEET TO THE POINT OF CURVATURE OF A CURVE CONCAVE SOUTHEASTERLY AND HAVING A RADIUS OF 122.50 FEET; THENCE SOUTHWESTERLY ALONG THE ARC OF SAID CURVE THROUGH A CENTRAL ANGLE OF 19°37'20", AN ARC DISTANCE OF 41.95 FEET TO THE POINT OF TANGENCY; THENCE S19°05'31"W, 11.43 FEET TO THE POINT OF CURVATURE OF A CURVE CONCAVE EASTERLY AND HAVING A RADIUS OF 107.50 FEET; THENCE SOUTHERLY ALONG THE ARC OF SAID CURVE THROUGH A CENTRAL ANGLE OF 34°13'09", AN ARC DISTANCE OF 64.20 FEET TO THE POINT OF TANGENCY; THENCE S15°07'38"E, 10.32 FEET TO THE POINT OF CURVATURE OF A CURVE CONCAVE EASTERLY AND HAVING A RADIUS OF 94.50 FEET; THENCE SOUTHERLY ALONG THE ARC OF SAID CURVE THROUGH A CENTRAL ANGLE OF 04°14'45", AN ARC DISTANCE OF 7.00 FEET TO A POINT ON A NON-TANGENT LINE; THENCE S75°23'44"W, 133.41 FEET; THENCE N57°33'20"W, 178.49 FEET TO A POINT ON THE ARC OF A NON-TANGENT CURVE CONCAVE SOUTHWESTERLY, HAVING A RADIUS OF 1,595.32 FEET AND A CHORD BEARING AND DISTANCE OF N60°24'07"W, 131.31 FEET TO WHICH A RADIAL LINE BEARS N31°57'24"E; THENCE NORTHWESTERLY ALONG THE ARC OF SAID CURVE, THROUGH A CENTRAL ANGLE OF 04°43'02", AN ARC DISTANCE OF 131.34 FEET TO THE POINT OF COMPOUND CURVATURE OF A CURVE CONCAVE SOUTHERLY AND HAVING A RADIUS OF 1,153.68 FEET; THENCE WESTERLY ALONG THE ARC OF SAID CURVE THROUGH A CENTRAL ANGLE OF 11°41'16", AN ARC DISTANCE OF 235.34 FEET TO THE POINT OF COMPOUND CURVATURE OF A CURVE CONCAVE SOUTHERLY AND HAVING A RADIUS OF 1,770.03 FEET; THENCE WESTERLY ALONG THE ARC OF SAID CURVE THROUGH A CENTRAL ANGLE OF 02°48'11", AN ARC DISTANCE OF 86.60 FEET TO A POINT ON THE ARC OF A NON-TANGENT CURVE CONCAVE WESTERLY, HAVING A RADIUS OF 260.00 FEET AND A CHORD BEARING AND DISTANCE OF S03°30'24"E, 38.33 FEET TO WHICH A RADIAL LINE BEARS N82°15'59"E; SAID POINT ALSO BEING THE POINT OF BEGINNING; THENCE DEPARTING AFORESAID BOUNDARY RUN SOUTHERLY ALONG THE ARC OF SAID CURVE, THROUGH A

CENTRAL ANGLE OF 08°27'13", AN ARC DISTANCE OF 38.36 FEET TO THE POINT OF TANGENCY; THENCE S00°43'12"W, 582.53 FEET TO THE POINT OF CURVATURE OF A CURVE CONCAVE EASTERLY AND HAVING A RADIUS OF 310.00 FEET; THENCE SOUTHERLY ALONG THE ARC OF SAID CURVE THROUGH A CENTRAL ANGLE OF 11°18'58", AN ARC DISTANCE OF 61.23 FEET TO THE POINT OF REVERSE CURVATURE OF A CURVE CONCAVE NORTHWESTERLY AND HAVING A RADIUS OF 35.00 FEET; THENCE SOUTHWESTERLY ALONG THE ARC OF SAID CURVE THROUGH A CENTRAL ANGLE OF 78°16'52", AN ARC DISTANCE OF 47.82 FEET TO THE POINT OF REVERSE CURVATURE OF A CURVE CONCAVE SOUTHEASTERLY AND HAVING A RADIUS OF 1,027.55 FEET; THENCE SOUTHWESTERLY ALONG THE ARC OF SAID CURVE THROUGH A CENTRAL ANGLE OF 05°55'10", AN ARC DISTANCE OF 106.16 FEET TO A POINT ON A RADIAL LINE; THENCE N28°14'03"W, ALONG SAID RADIAL LINE A DISTANCE OF 111.38 FEET; THENCE N75°46'42"W, 197.54 FEET; THENCE N01°51'44"W, 368.48 FEET; THENCE N19°53'49"W, 32.30 FEET; THENCE N01°51'44"W, 63.00 FEET; THENCE N45°09'06"E, 269.74 FEET TO A POINT ON THE ARC OF A NON-TANGENT CURVE CONCAVE SOUTHERLY, HAVING A RADIUS OF 1,770.03 FEET AND A CHORD BEARING AND DISTANCE OF S80°26'57"E, 197.47 FEET TO WHICH A RADIAL LINE BEARS N06°21'11"E; SAID POINT ALSO BEING ON SAID BOUNDARY OF THE LANDS DESCRIBED IN OFFICIAL RECORDS BOOK 1811, PAGE 409; THENCE EASTERLY ALONG THE ARC OF SAID CURVE AND SAID BOUNDARY, THROUGH A CENTRAL ANGLE OF 06°23'44", AN ARC DISTANCE OF 197.58 FEET TO THE POINT OF BEGINNING.

AND

THAT LAND LYING IN SECTION 8, TOWNSHIP 19 SOUTH, RANGE 23 EAST, SUMTER COUNTY, FLORIDA, DESCRIBED AS FOLLOWS:

BEGIN AT THE MOST WESTERLY CORNER OF LOT 32, VILLAGES OF WILDWOOD ALDEN BUNGALOWS, ACCORDING TO THE PLAT THEREOF AS RECORDED IN PAT BOOK 15, PAGES 20, 20A THROUGH 20D, INCLUSIVE, PUBLIC RECORDS OF SUMTER COUNTY, FLORIDA; THE FOLLOWING NINE (9) COURSES BEING ALONG THE SOUTHWESTERLY BOUNDARY LINE OF LOTS 10 THROUGH 32, INCLUSIVE, AND TRACT 'H' OF AFORESAID PLAT: RUN S65°11'41"E, 656.85 FEET; THENCE S70°02'15"E, 57.09 FEET; THENCE S75°49'16"E, 61.91 FEET; THENCE S81°27'56"E, 61.87 FEET; THENCE S86°19'02"E, 51.75 FEET; THENCE S82°26'11"E, 47.51 FEET; THENCE S75°37'23"E, 40.55 FEET; THENCE S69°21'04"E, 40.55 FEET; THENCE S66°22'30"E, 309.36 FEET TO A POINT ON THE ARC OF A NON-TANGENT CURVE CONCAVE SOUTHEASTERLY, HAVING A RADIUS OF 760.00 FEET AND A CHORD BEARING AND DISTANCE OF S30°34'55"W, 129.89 FEET TO WHICH A RADIAL LINE BEARS N54°30'57"W; SAID POINT ALSO BEING ON THE WESTERLY RIGHT OF WAY LINE OF POWELL ROAD PER OFFICIAL RECORDS BOOK 2088, PAGE 199, PUBLIC RECORDS OF SUMTER COUNTY, FLORIDA; THE FOLLOWING THREE (3) COURSES BEING ALONG SAID WESTERLY RIGHT OF WAY LINE AND WESTERLY RIGHT OF WAY LINE OF SAID POWELL ROAD PER OFFICIAL RECORDS BOOK 2434, PAGE 807, PUBLIC RECORDS OF SUMTER COUNTY, FLORIDA: RUN SOUTHWESTERLY ALONG THE ARC

OF SAID CURVE, THROUGH A CENTRAL ANGLE OF  $09^{\circ}48'16''$ , AN ARC DISTANCE OF 130.05 FEET TO THE POINT OF REVERSE CURVATURE OF A CURVE CONCAVE NORTHWESTERLY AND HAVING A RADIUS OF 50.25 FEET; THENCE SOUTHWESTERLY ALONG THE ARC OF SAID CURVE THROUGH A CENTRAL ANGLE OF  $47^{\circ}00'26''$ , AN ARC DISTANCE OF 41.23 FEET TO THE POINT OF REVERSE CURVATURE OF A CURVE CONCAVE SOUTHEASTERLY AND HAVING A RADIUS OF 129.75 FEET; THENCE SOUTHWESTERLY ALONG THE ARC OF SAID CURVE THROUGH A CENTRAL ANGLE OF  $44^{\circ}04'57''$ , AN ARC DISTANCE OF 99.83 FEET TO A POINT ON THE ARC OF A NON-TANGENT CURVE CONCAVE NORTHERLY, HAVING A RADIUS OF 87.50 FEET AND A CHORD BEARING AND DISTANCE OF  $N87^{\circ}39'22''W$ , 31.37 FEET TO WHICH A RADIAL LINE BEARS  $S07^{\circ}58'55''E$ ; THENCE WESTERLY ALONG THE ARC OF SAID CURVE, THROUGH A CENTRAL ANGLE OF  $20^{\circ}39'05''$ , AN ARC DISTANCE OF 31.54 FEET TO THE POINT OF TANGENCY; THENCE  $N77^{\circ}19'50''W$ , 41.25 FEET TO THE POINT OF CURVATURE OF A CURVE CONCAVE SOUTHERLY AND HAVING A RADIUS OF 630.00 FEET; THENCE WESTERLY ALONG THE ARC OF SAID CURVE THROUGH A CENTRAL ANGLE OF  $20^{\circ}14'03''$ , AN ARC DISTANCE OF 222.49 FEET TO THE POINT OF TANGENCY; THENCE  $S82^{\circ}26'07''W$ , 147.66 FEET TO THE POINT OF CURVATURE OF A CURVE CONCAVE SOUTHERLY AND HAVING A RADIUS OF 313.09 FEET; THENCE WESTERLY ALONG THE ARC OF SAID CURVE THROUGH A CENTRAL ANGLE OF  $19^{\circ}31'46''$ , AN ARC DISTANCE OF 106.72 FEET TO THE POINT OF REVERSE CURVATURE OF A CURVE CONCAVE NORTHERLY AND HAVING A RADIUS OF 122.50 FEET; THENCE WESTERLY ALONG THE ARC OF SAID CURVE THROUGH A CENTRAL ANGLE OF  $56^{\circ}24'22''$ , AN ARC DISTANCE OF 120.60 FEET TO THE POINT OF REVERSE CURVATURE OF A CURVE CONCAVE SOUTHERLY AND HAVING A RADIUS OF 379.50 FEET; THENCE WESTERLY ALONG THE ARC OF SAID CURVE THROUGH A CENTRAL ANGLE OF  $17^{\circ}36'18''$ , AN ARC DISTANCE OF 116.61 FEET TO THE POINT OF COMPOUND CURVATURE OF A CURVE CONCAVE SOUTHERLY AND HAVING A RADIUS OF 592.50 FEET; THENCE WESTERLY ALONG THE ARC OF SAID CURVE THROUGH A CENTRAL ANGLE OF  $10^{\circ}28'19''$ , AN ARC DISTANCE OF 108.29 FEET TO THE POINT OF REVERSE CURVATURE OF A CURVE CONCAVE NORTHERLY AND HAVING A RADIUS OF 485.50 FEET; THENCE WESTERLY ALONG THE ARC OF SAID CURVE THROUGH A CENTRAL ANGLE OF  $11^{\circ}02'56''$ , AN ARC DISTANCE OF 93.62 FEET; THENCE ALONG A NON-TANGENT LINE RUN  $N02^{\circ}38'27''W$ , 31.43 FEET TO A POINT ON THE ARC OF A NON-TANGENT CURVE CONCAVE NORTHERLY, HAVING A RADIUS OF 235.00 FEET AND A CHORD BEARING AND DISTANCE OF  $N80^{\circ}13'15''W$ , 101.20 FEET TO WHICH A RADIAL LINE BEARS  $S02^{\circ}39'20''E$ ; THENCE WESTERLY ALONG THE ARC OF SAID CURVE, THROUGH A CENTRAL ANGLE OF  $24^{\circ}52'10''$ , AN ARC DISTANCE OF 102.00 FEET TO THE POINT OF TANGENCY; THENCE  $N67^{\circ}47'10''W$ , 247.20 FEET; THENCE  $N24^{\circ}48'19''E$ , 442.03 FEET; THENCE  $N27^{\circ}23'11''E$ , 85.54 FEET TO A POINT ON THE BOUNDARY LINE OF EASEMENT PER OFFICIAL RECORDS BOOK 2973, PAGE 546, PUBLIC RECORDS OF SUMTER COUNTY, FLORIDA; THE FOLLOWING TWO (2) COURSES BEING ALONG SAID BOUNDARY OF EASEMENT: RUN  $N60^{\circ}12'34''E$ , 1.98 FEET; THENCE  $N24^{\circ}48'19''E$ , 23.84 FEET TO THE POINT OF BEGINNING.

AND:

THOSE PORTIONS OF TRACT 14, TRACT 15 AND BROWNWOOD BOULEVARD, VACATED PER RESOLUTION IN OFFICIAL RECORDS BOOK 3428, PAGE 242, PUBLIC RECORDS OF SUMTER COUNTY, FLORIDA; ALL WITHIN BROWNWOOD DOWNTOWN, ACCORDING TO THE PLAT THEREOF AS RECORDED IN PLAT BOOK 15, PAGES 6, 6A THROUGH 6I, INCLUSIVE, PUBLIC RECORDS OF SUMTER COUNTY, FLORIDA, AND BEING MORE PARTICULARLY DESCRIBED AS FOLLOWS:

BEGIN AT THE MOST SOUTHERLY CORNER OF AFORESAID TRACT 14; THE FOLLOWING THREE (3) COURSES BEING ALONG THE SOUTHERLY BOUNDARY LINES OF AFORESAID TRACT 14 AND BROWNWOOD BOULEVARD; SAID POINT BEING ON A CURVE CONCAVE SOUTHWESTERLY AND HAVING A RADIUS OF 530.00 FEET AND A CHORD BEARING AND DISTANCE OF N24°18'18"W, 231.14 FEET TO WHICH A RADIAL LINE BEARS N78°17'23"E; THENCE NORTHWESTERLY ALONG THE ARC OF SAID CURVE, THROUGH A CENTRAL ANGLE OF 25°11'22", A DISTANCE OF 233.01 FEET TO THE POINT OF COMPOUND CURVATURE OF A CURVE CONCAVE SOUTHWESTERLY AND HAVING A RADIUS OF 580.00 FEET; THENCE NORTHWESTERLY ALONG THE ARC OF SAID CURVE THROUGH A CENTRAL ANGLE OF 22°14'36", AN ARC DISTANCE OF 225.17 FEET TO THE POINT OF COMPOUND CURVATURE OF A CURVE CONCAVE SOUTHERLY AND HAVING A RADIUS OF 1,330.00 FEET; THENCE WESTERLY ALONG THE ARC OF SAID CURVE THROUGH A CENTRAL ANGLE OF 00°49'38", AN ARC DISTANCE OF 19.21 FEET TO A POINT ON THE ARC OF A NON-TANGENT CURVE CONCAVE EASTERLY, HAVING A RADIUS OF 9.33 FEET AND A CHORD BEARING AND DISTANCE OF N18°41'49"E, 1.99 FEET TO WHICH A RADIAL LINE BEARS N77°26'11"W; THENCE DEPARTING SAID SOUTHERLY BOUNDARY LINE RUN NORTHERLY ALONG THE ARC OF SAID CURVE, THROUGH A CENTRAL ANGLE OF 12°15'59", AN ARC DISTANCE OF 2.00 FEET TO THE POINT OF TANGENCY; THENCE N24°49'48"E, 14.85 FEET TO THE POINT OF CURVATURE OF A CURVE CONCAVE SOUTHERLY AND HAVING A RADIUS OF 1.33 FEET; THENCE EASTERLY ALONG THE ARC OF SAID CURVE THROUGH A CENTRAL ANGLE OF 90°00'00", AN ARC DISTANCE OF 2.09 FEET TO THE POINT OF TANGENCY; THENCE S65°10'12"E, 14.00 FEET; THENCE N24°49'48"E, 113.31 FEET TO A POINT ON THE ARC OF A NON-TANGENT CURVE CONCAVE NORTHWESTERLY, HAVING A RADIUS OF 60.67 FEET AND A CHORD BEARING AND DISTANCE OF N66°44'13"E, 54.81 FEET TO WHICH A RADIAL LINE BEARS S03°35'24"W; THENCE NORTHEASTERLY ALONG THE ARC OF SAID CURVE, THROUGH A CENTRAL ANGLE OF 53°42'21", AN ARC DISTANCE OF 56.87 FEET; THENCE ALONG A NON-TANGENT LINE RUN N60°43'08"E, 13.66 FEET; THENCE S80°28'44"E, 31.34 FEET; THENCE N09°31'16"E, 55.43 FEET TO A POINT ON THE ARC OF A NON-TANGENT CURVE CONCAVE SOUTHERLY, HAVING A RADIUS OF 50.67 FEET AND A CHORD BEARING AND DISTANCE OF S85°55'38"W, 21.06 FEET TO WHICH A RADIAL LINE BEARS N07°55'24"E; THENCE WESTERLY ALONG THE ARC OF SAID CURVE, THROUGH A CENTRAL ANGLE OF 23°59'33", AN ARC DISTANCE OF 21.22 FEET TO THE POINT OF REVERSE CURVATURE OF A CURVE CONCAVE NORTHEASTERLY AND HAVING A RADIUS OF 29.33 FEET; THENCE NORTHWESTERLY ALONG THE ARC OF SAID CURVE THROUGH A CENTRAL ANGLE OF 79°07'16", AN ARC DISTANCE OF 40.50 FEET TO THE POINT OF REVERSE CURVATURE OF A CURVE CONCAVE SOUTHWESTERLY AND HAVING A RADIUS OF 42.67 FEET; THENCE NORTHWESTERLY ALONG THE ARC OF SAID CURVE THROUGH A CENTRAL ANGLE OF

05°17'46", AN ARC DISTANCE OF 3.94 FEET TO THE POINT OF REVERSE CURVATURE OF A CURVE CONCAVE EASTERLY AND HAVING A RADIUS OF 19.33 FEET; THENCE NORTHERLY ALONG THE ARC OF SAID CURVE THROUGH A CENTRAL ANGLE OF 57°04'26", AN ARC DISTANCE OF 19.26 FEET TO THE POINT OF TANGENCY; THENCE N24°49'48"E, 3.74 FEET; THENCE N20°33'38"E, 13.61 FEET TO THE NORTHERLY BOUNDARY LINE OF AFORESAID BROWNWOOD BOULEVARD; THENCE ALONG SAID NORTHERLY BOUNDARY LINE RUN S65°10'12"E, 11.62 FEET TO THE MOST NORTHERLY CORNER OF AFORESAID TRACT 15; THE FOLLOWING TWO (2) COURSES BEING ALONG THE BOUNDARY LINES OF SAID TRACT 15: RUN S65°09'28"E, 78.29 FEET; THENCE S24°50'32"W, 2.25 FEET TO A POINT ON THE BOUNDARY OF AFORESAID TRACT 14; THE FOLLOWING SEVEN (7) COURSES BEING ALONG THE BOUNDARY LINES OF SAID TRACT 14: RUN S65°09'28"E, 371.50 FEET; THENCE S24°45'38"W, 60.69 FEET; THENCE S65°29'03"E, 66.30 FEET; THENCE S18°16'44"W, 23.89 FEET; THENCE S65°11'44"E, 69.17 FEET; THENCE S37°05'23"W, 27.42 FEET; THENCE S51°58'15"W, 422.27 FEET TO THE POINT OF BEGINNING.

AND:

THOSE PORTIONS OF TRACT 9, TRACT 13 AND BROWNWOOD BOULEVARD, VACATED PER RESOLUTION IN OFFICIAL RECORDS BOOK 3428, PAGE 242, PUBLIC RECORDS OF SUMTER COUNTY, FLORIDA; ALL WITHIN BROWNWOOD DOWNTOWN, ACCORDING TO THE PLAT THEREOF AS RECORDED IN PLAT BOOK 15, PAGES 6, 6A THROUGH 6I, INCLUSIVE, PUBLIC RECORDS OF SUMTER COUNTY, FLORIDA, AND BEING MORE PARTICULARLY DESCRIBED AS FOLLOWS:

COMMENCE AT THE MOST SOUTHERLY CORNER OF TRACT 14, BROWNWOOD DOWNTOWN, ACCORDING TO THE PLAT THEREOF AS RECORDED IN PLAT BOOK 15, PAGES 6, 6A THROUGH 6I, INCLUSIVE, PUBLIC RECORDS OF SUMTER COUNTY, FLORIDA; THE FOLLOWING TWENTY-FIVE (25) COURSES BEING ALONG THE SOUTHERLY, WESTERLY AND NORTHERLY BOUNDARY LINES, RESPECTIVELY, OF AFORESAID TRACT 14, BROWNWOOD BOULEVARD AND TRACT 9; SAID POINT BEING ON A CURVE CONCAVE SOUTHWESTERLY AND HAVING A RADIUS OF 530.00 FEET AND A CHORD BEARING AND DISTANCE OF N24°18'18"W, 231.14 FEET TO WHICH A RADIAL LINE BEARS N78°17'23"E; THENCE NORTHWESTERLY ALONG THE ARC OF SAID CURVE, THROUGH A CENTRAL ANGLE OF 25°11'22", A DISTANCE OF 233.01 FEET TO THE POINT OF COMPOUND CURVATURE OF A CURVE CONCAVE SOUTHWESTERLY AND HAVING A RADIUS OF 580.00 FEET; THENCE NORTHWESTERLY ALONG THE ARC OF SAID CURVE THROUGH A CENTRAL ANGLE OF 22°14'36", AN ARC DISTANCE OF 225.17 FEET TO THE POINT OF COMPOUND CURVATURE OF A CURVE CONCAVE SOUTHERLY AND HAVING A RADIUS OF 1,330.00 FEET; THENCE WESTERLY ALONG THE ARC OF SAID CURVE THROUGH A CENTRAL ANGLE OF 02°10'41", AN ARC DISTANCE OF 50.56 FEET TO THE POINT OF BEGINNING; THENCE CONTINUE WESTERLY ALONG SAID CURVE THROUGH A CENTRAL ANGLE OF 23°20'40", A DISTANCE OF 541.89 FEET TO A POINT OF COMPOUND CURVATURE OF A CURVE CONCAVE SOUTHERLY AND HAVING A RADIUS OF 675.00 FEET; THENCE WESTERLY ALONG THE ARC OF SAID CURVE THROUGH A CENTRAL ANGLE OF 18°42'28", AN ARC DISTANCE OF 220.40

FEET TO A POINT OF COMPOUND CURVATURE OF A CURVE CONCAVE SOUTHEASTERLY AND HAVING A RADIUS OF 395.00 FEET; THENCE SOUTHWESTERLY ALONG THE ARC OF SAID CURVE THROUGH A CENTRAL ANGLE OF 28°56'16", AN ARC DISTANCE OF 199.50 FEET TO THE POINT OF REVERSE CURVATURE OF A CURVE CONCAVE NORTHERLY AND HAVING A RADIUS OF 25.00 FEET; THENCE WESTERLY ALONG THE ARC OF SAID CURVE THROUGH A CENTRAL ANGLE OF 83°29'34", AN ARC DISTANCE OF 36.43 FEET TO THE POINT OF REVERSE CURVATURE OF A CURVE CONCAVE SOUTHWESTERLY AND HAVING A RADIUS OF 530.00 FEET; THENCE NORTHWESTERLY ALONG THE ARC OF SAID CURVE THROUGH A CENTRAL ANGLE OF 04°05'19", AN ARC DISTANCE OF 37.82 FEET TO THE POINT OF TANGENCY; THENCE N52°54'25"W, 59.10 FEET TO THE POINT OF CURVATURE OF A CURVE CONCAVE NORTHEASTERLY AND HAVING A RADIUS OF 270.00 FEET; THENCE NORTHWESTERLY ALONG THE ARC OF SAID CURVE THROUGH A CENTRAL ANGLE OF 05°48'53", AN ARC DISTANCE OF 27.40 FEET; THENCE ALONG A NON-TANGENT LINE RUN N43°58'08"E, 5.00 FEET TO A POINT ON THE ARC OF A NON-TANGENT CURVE CONCAVE NORTHEASTERLY, HAVING A RADIUS OF 265.00 FEET AND A CHORD BEARING AND DISTANCE OF N43°59'27"W, 28.86 FEET TO WHICH A RADIAL LINE BEARS S42°53'16"W; THENCE NORTHWESTERLY ALONG THE ARC OF SAID CURVE, THROUGH A CENTRAL ANGLE OF 06°14'35", AN ARC DISTANCE OF 28.88 FEET; THENCE ALONG A NON-TANGENT LINE RUN N19°35'24"E, 76.10 FEET TO A POINT ON THE ARC OF A NON-TANGENT CURVE CONCAVE NORTHWESTERLY, HAVING A RADIUS OF 857.13 FEET AND A CHORD BEARING AND DISTANCE OF N43°28'42"E, 426.23 FEET TO WHICH A RADIAL LINE BEARS S32°07'28"E; THENCE NORTHEASTERLY ALONG THE ARC OF SAID CURVE, THROUGH A CENTRAL ANGLE OF 28°47'38", AN ARC DISTANCE OF 430.75 FEET; THENCE ALONG A NON-TANGENT LINE RUN N28°48'33"E, 42.66 FEET; THENCE S65°47'44"E, 48.66 FEET TO A POINT ON THE ARC OF A NON-TANGENT CURVE CONCAVE NORTHERLY, HAVING A RADIUS OF 406.78 FEET AND A CHORD BEARING AND DISTANCE OF S80°25'17"E, 104.32 FEET TO WHICH A RADIAL LINE BEARS S16°56'44"W; THENCE EASTERLY ALONG THE ARC OF SAID CURVE, THROUGH A CENTRAL ANGLE OF 14°44'02", AN ARC DISTANCE OF 104.60 FEET; THENCE ALONG A NON-TANGENT LINE RUN S85°47'03"E, 43.75 FEET; THENCE S70°38'45"E, 55.89 FEET; THENCE S65°05'00"E, 225.09 FEET TO A POINT ON THE ARC OF A NON-TANGENT CURVE CONCAVE SOUTHWESTERLY, HAVING A RADIUS OF 199.67 FEET AND A CHORD BEARING AND DISTANCE OF S62°13'59"E, 20.73 FEET TO WHICH A RADIAL LINE BEARS N24°47'28"E; THENCE SOUTHEASTERLY ALONG THE ARC OF SAID CURVE, THROUGH A CENTRAL ANGLE OF 05°57'06", AN ARC DISTANCE OF 20.74 FEET TO THE POINT OF REVERSE CURVATURE OF A CURVE CONCAVE NORTHEASTERLY AND HAVING A RADIUS OF 553.33 FEET; THENCE SOUTHEASTERLY ALONG THE ARC OF SAID CURVE THROUGH A CENTRAL ANGLE OF 11°54'12", AN ARC DISTANCE OF 114.95 FEET TO THE POINT OF REVERSE CURVATURE OF A CURVE CONCAVE SOUTHERLY AND HAVING A RADIUS OF 199.67 FEET; THENCE EASTERLY ALONG THE ARC OF SAID CURVE THROUGH A CENTRAL ANGLE OF 05°57'06", AN ARC DISTANCE OF 20.74 FEET; THENCE ALONG A NON-TANGENT LINE RUN S65°19'45"E, 54.26 FEET; THENCE S63°26'02"E, 121.72 FEET TO A POINT ON THE BOUNDARY OF AFORESAID TRACT 13; THENCE ALONG SAID BOUNDARY OF TRACT 13 RUN N26°33'58"E, 4.60 FEET; THENCE DEPARTING SAID BOUNDARY RUN S61°25'11"E, 8.00 FEET; THENCE S68°34'55"E, 26.76 FEET; THENCE S70°21'35"E, 18.69 FEET TO A POINT ON THE BOUNDARY OF

AFORESAID TRACT 13; THENCE ALONG SAID BOUNDARY RUN S63°26'02"E, 31.78 FEET TO THE NORTHERLY BOUNDARY LINE OF AFORESAID BROWNWOOD BOULEVARD; THENCE ALONG SAID NORTHERLY BOUNDARY LINE RUN S65°10'12"E, 11.53 FEET; THENCE DEPARTING SAID NORTHERLY BOUNDARY LINE RUN S28°12'25"W, 13.60 FEET; THENCE S24°49'48"W, 3.69 FEET TO THE POINT OF CURVATURE OF A CURVE CONCAVE NORTHWESTERLY AND HAVING A RADIUS OF 19.33 FEET; THENCE SOUTHWESTERLY ALONG THE ARC OF SAID CURVE THROUGH A CENTRAL ANGLE OF 57°09'21", AN ARC DISTANCE OF 19.28 FEET TO THE POINT OF REVERSE CURVATURE OF A CURVE CONCAVE SOUTHERLY AND HAVING A RADIUS OF 42.67 FEET; THENCE WESTERLY ALONG THE ARC OF SAID CURVE THROUGH A CENTRAL ANGLE OF 20°33'01", AN ARC DISTANCE OF 15.30 FEET TO THE POINT OF REVERSE CURVATURE OF A CURVE CONCAVE NORTHERLY AND HAVING A RADIUS OF 34.33 FEET; THENCE WESTERLY ALONG THE ARC OF SAID CURVE THROUGH A CENTRAL ANGLE OF 82°50'27", AN ARC DISTANCE OF 49.64 FEET TO THE POINT OF TANGENCY; THENCE N35°43'25"W, 44.21 FEET; THENCE S54°16'35"W, 58.34 FEET; THENCE N35°43'25"W, 14.86 FEET TO THE POINT OF CURVATURE OF A CURVE CONCAVE SOUTHWESTERLY AND HAVING A RADIUS OF 20.00 FEET; THENCE NORTHWESTERLY ALONG THE ARC OF SAID CURVE THROUGH A CENTRAL ANGLE OF 36°15'18", AN ARC DISTANCE OF 12.66 FEET TO THE POINT OF TANGENCY; THENCE N71°58'42"W, 38.02 FEET; THENCE S18°01'18"W, 29.67 FEET; THENCE S71°58'42"E, 20.11 FEET; THENCE S18°01'18"W, 4.59 FEET TO THE POINT OF CURVATURE OF A CURVE CONCAVE NORTHWESTERLY AND HAVING A RADIUS OF 16.55 FEET; THENCE SOUTHWESTERLY ALONG THE ARC OF SAID CURVE THROUGH A CENTRAL ANGLE OF 54°15'55", AN ARC DISTANCE OF 15.68 FEET TO THE POINT OF REVERSE CURVATURE OF A CURVE CONCAVE SOUTHEASTERLY AND HAVING A RADIUS OF 45.94 FEET; THENCE SOUTHWESTERLY ALONG THE ARC OF SAID CURVE THROUGH A CENTRAL ANGLE OF 81°29'18", AN ARC DISTANCE OF 65.33 FEET TO THE POINT OF REVERSE CURVATURE OF A CURVE CONCAVE WESTERLY AND HAVING A RADIUS OF 72.81 FEET; THENCE SOUTHERLY ALONG THE ARC OF SAID CURVE THROUGH A CENTRAL ANGLE OF 33°40'49", AN ARC DISTANCE OF 42.80 FEET; THENCE ALONG A NON-TANGENT LINE RUN S24°11'54"W, 25.94 FEET; THENCE S65°48'02"E, 78.14 FEET; THENCE S24°11'58"W, 4.93 FEET TO THE POINT OF CURVATURE OF A CURVE CONCAVE EASTERLY AND HAVING A RADIUS OF 9.00 FEET; THENCE SOUTHERLY ALONG THE ARC OF SAID CURVE THROUGH A CENTRAL ANGLE OF 90°00'03", AN ARC DISTANCE OF 14.14 FEET TO THE POINT OF TANGENCY; THENCE S65°48'06"E, 68.66 FEET TO THE POINT OF CURVATURE OF A CURVE CONCAVE WESTERLY AND HAVING A RADIUS OF 4.00 FEET; THENCE SOUTHERLY ALONG THE ARC OF SAID CURVE THROUGH A CENTRAL ANGLE OF 94°30'06", AN ARC DISTANCE OF 6.60 FEET; THENCE ALONG A NON-TANGENT LINE RUN S28°40'43"W, 2.15 FEET TO THE POINT OF BEGINNING.

## EXHIBIT "5"

### Board of Supervisors

1. Kent Kluver
2. Jack Reimer
3. David Green
4. Don Hickman
5. Steve Brown

## EXHIBIT 6

All property to be included is within the Villages of Wildwood Development of Regional Impact.

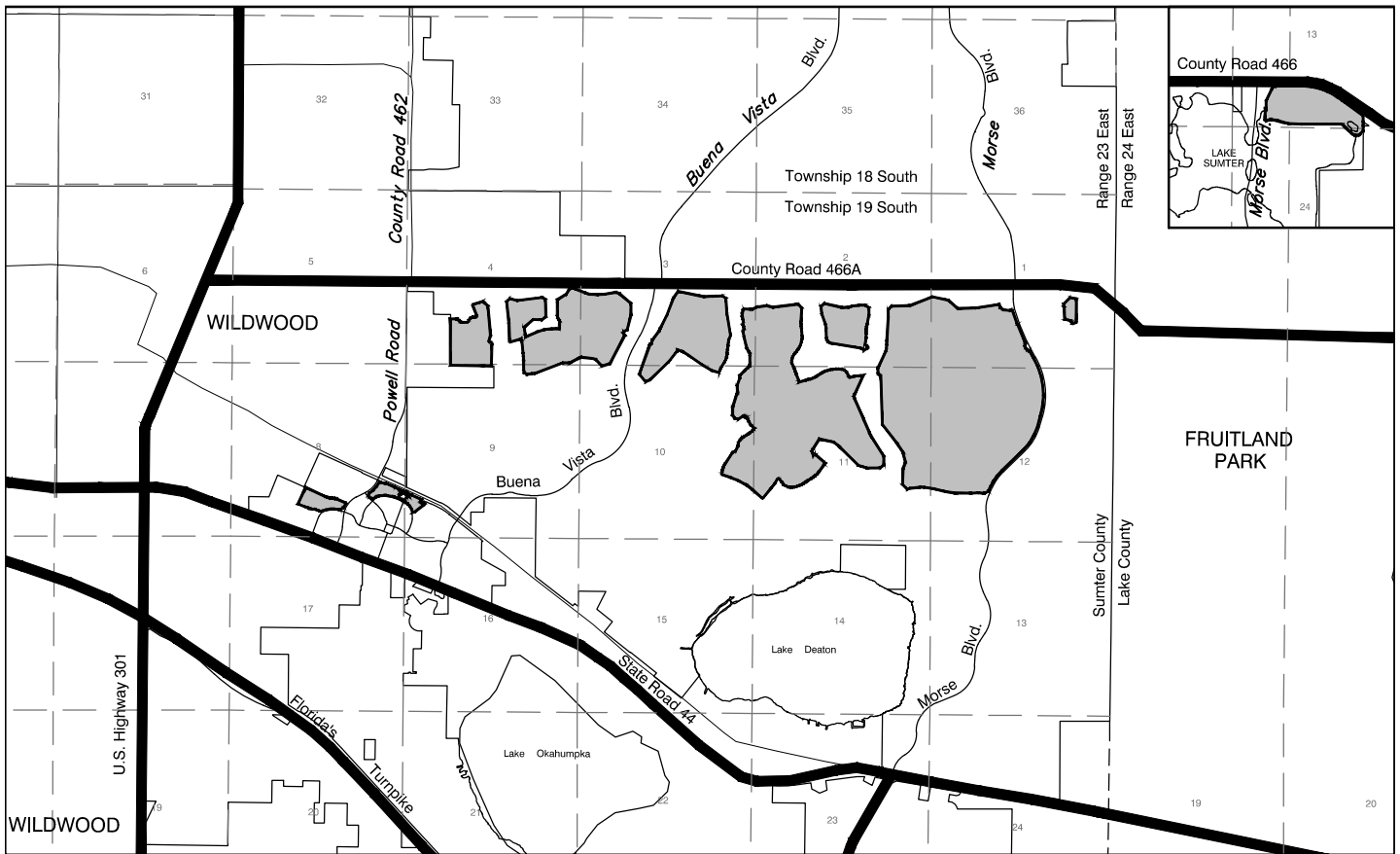

**SECTOR PLAN**